



PRICED AT
\$1,299,900

 4319 Sq Ft

 5 Beds

 5.0 Baths

 3 Car Garage

 2.0 Story

FORMER BELLMOORE PARK MODEL HOME..NEVER LIVED IN, (THIS IS BEING SOLD BY THE BUILDER)..FINALLY, THE HOME EVERYONE HAS WANTED IS NOW AVAILABLE!!! DON'T MISS THIS OPPORTUNITY TO CALL THIS AMAZING HOME YOUR OWN. THE MATHEWS MODEL HOME HAS BEEN UPDATED WITH NEW HARDWOOD FLOORING, FRESH PAINT AND INCLUDES REFRIGERATOR, WASHER & DRYER AND IS READY FOR YOUR QUICK MOVE IN, JUST IN TIME FOR SCHOOL. THIS STUNNING HOME OFFERS A GUEST SUITE WITH FULL BATH ON THE MAIN PLUS A SEPERATE POWDER ROOM (1/2 BATH), PRIVATE STUDY ON THE MAIN. THE MAIN FLOOR IS AN OPEN CONCEPT THAT OFFERS AN INCREDIBLE LAYOUT WITH A BEAUTIFUL KITCHEN THAT HAS AMAZING CABINETS TO THE CEILING, A HUGE WALK IN PANTRY. SECOND FLOOR YOU WILL ENJOY RELAXING EVENINGS WITH 3 BEDROOMS/2.5 BATHS PLUS AN OPEN LOFT AREA PERFECT FOR FAMILY TIME, STUDY TIME OR JUST HANGING OUT FUN TIMES! THE OWNERS RETREAT IS A FAN FAVORITE WITH A SPECTACULAR OWNERS BATH; SEPERATE HIS/HER VANITY SPACES, FRESS STANDING SOAKING TUB, FRAMELESS GLASS SHOWER. THE OWNERS CLOSET HAS A FULL CLOSET ORGANIZER COMPLETE WITH DRAWERS, HAMPERS AND TONS OF HANGING SPACE. THE 3RD FLOOR IS A SPECIAL PLACE WITH 1 BEDROOM WITH A PRIVATE FULL ...

**Want to Know More
About This Home?**

CONTACT OUR COMMUNITY SALES MANAGER
Call Us @ 770.580.9300



FIRST FLOOR

Elevation A

Want to Know More
About This Home?

CONTACT OUR COMMUNITY SALES MANAGER
Call Us @ 770.580.9300



SECOND FLOOR

Elevation A

Want to Know More
About This Home?

CONTACT OUR COMMUNITY SALES MANAGER
Call Us @ 770.580.9300

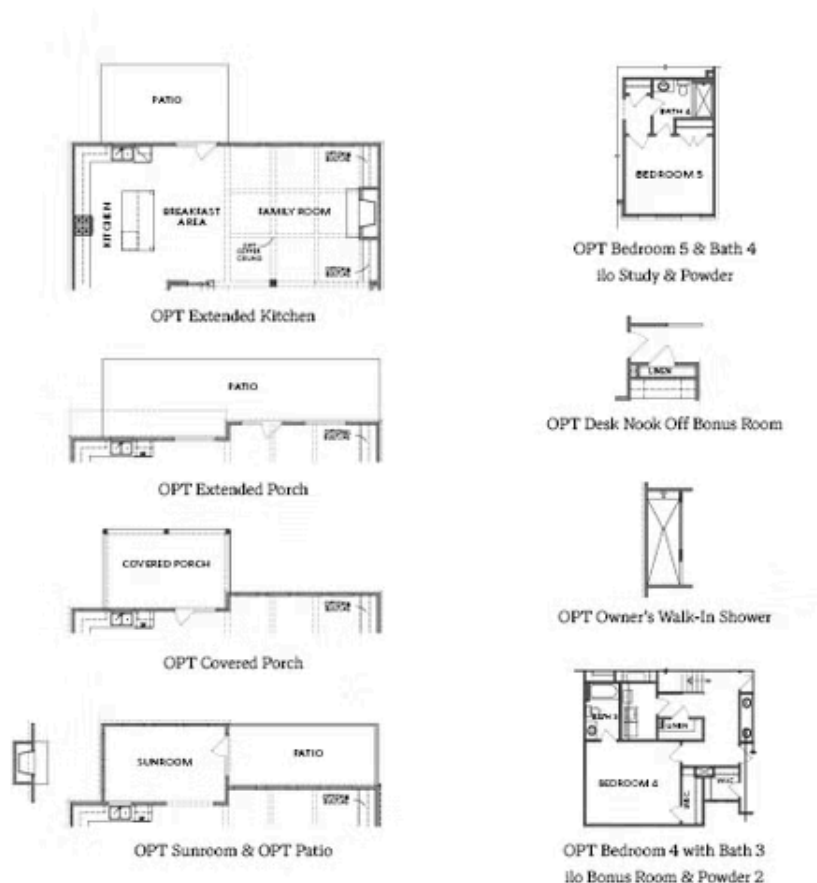

OPTIONS

Want to Know More
About This Home?

CONTACT OUR COMMUNITY SALES MANAGER
Call Us @ 770.580.9300



OPT Bedroom 7 and Full Bath 6 with Bonus Room Layout

OPTIONS

Want to Know More
About This Home?

CONTACT OUR COMMUNITY SALES MANAGER
Call Us @ 770.580.9300



OPT Bedroom 7 and Full Bath 6 with Bedroom 4 Layout

OPTIONS

Want to Know More
About This Home?

CONTACT OUR COMMUNITY SALES MANAGER
Call Us @ 770.580.9300