



PRICED AT  
**\$1,036,500**

 4055 Sq Ft

 6 Beds

 5.0 Baths

 2 Car Garage

 3.0 Story

THE MONTGOMERY C - Johns Creek. MOST REQUESTED HOME DESIGN!! This stunning THREE STORY HOME story home is on a nice flat lot in an award-winning neighborhood. From the open-concept kitchen and living space to the FLAT BACK YARD there is plenty of room for the whole family to enjoy. This Owners Retreat is your own personal Haven with an Incredible Spa like Retreat with Incredible Separate Vanity Spaces, separate soaking tub and great shower with bench seat, fantastic walk in Closet! Come see why EVERYONE LOVES THIS HOME. Structural options included 10' ceilings on the main level, extended kitchen and the awesome 3rd floor. Located in an Award winning school district! Bellmoore Park offers HOA maintained lawns, onsite fitness center, 6 tennis court, basketball court, pools, playground, clubhouse, splash pad, event lawns and a 24 HOUR MANNED GATEHOUSE. Convenient to shopping and entertainment Photos are not of actual home but of same home previously built in the community.

**Want to Know More  
About This Home?**

CONTACT OUR COMMUNITY SALES MANAGER  
Call Us @ 770.580.9300



Want to Know More  
About This Home?

CONTACT OUR COMMUNITY SALES MANAGER  
Call Us @ 770.580.9300

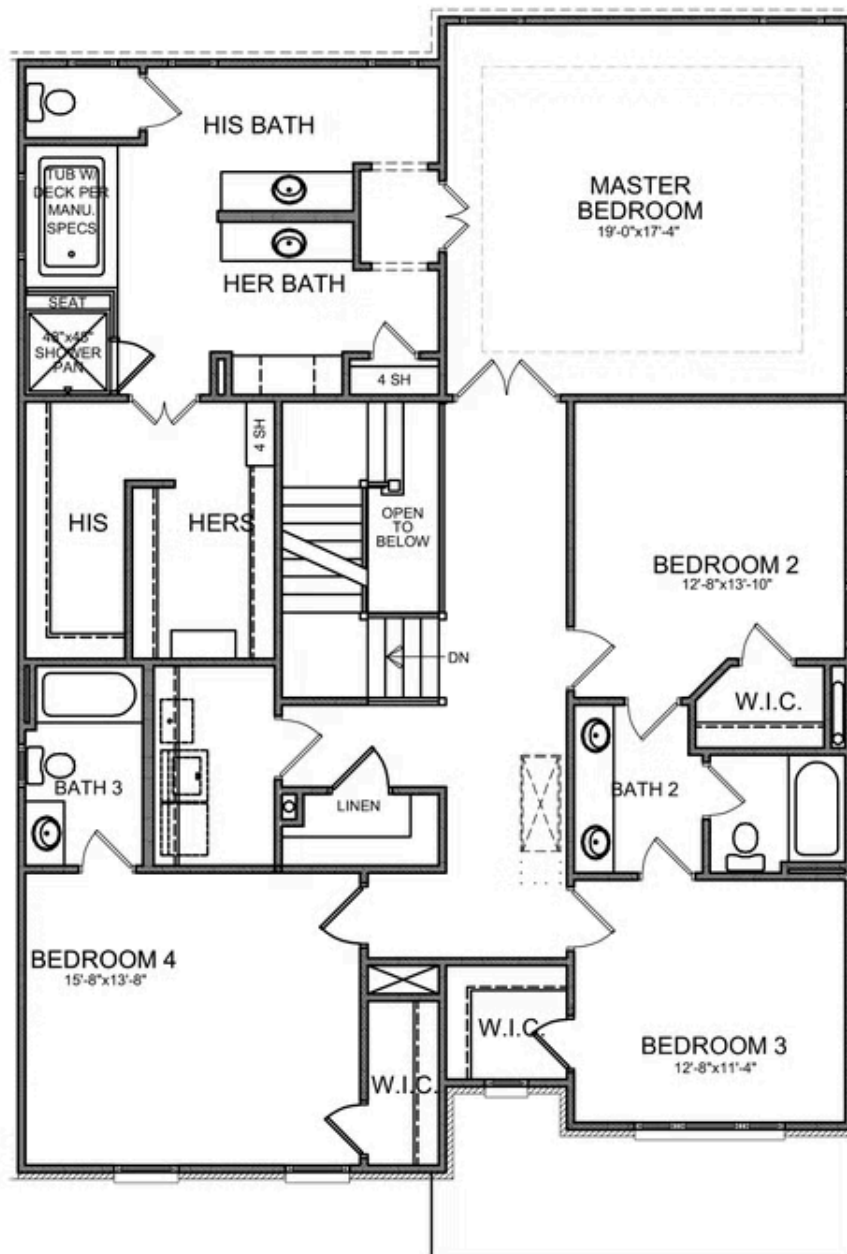

Want to Know More  
About This Home?

CONTACT OUR COMMUNITY SALES MANAGER  
Call Us @ 770.580.9300

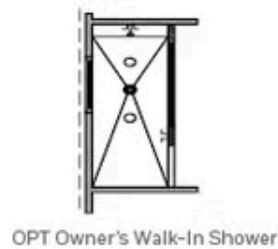

## OPTIONS

Want to Know More  
About This Home?

CONTACT OUR COMMUNITY SALES MANAGER  
Call Us @ 770.580.9300

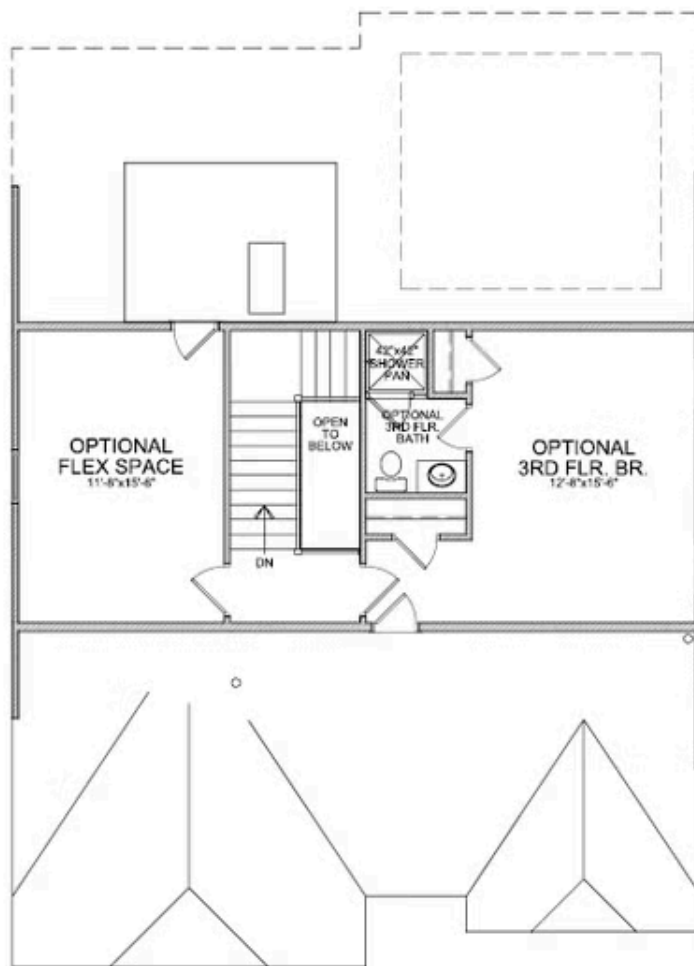

OPT Third Floor

\*Third Floor NOT available on Elevations B & E

Want to Know More  
About This Home?

CONTACT OUR COMMUNITY SALES MANAGER  
Call Us @ 770.580.9300