



PRICED AT
\$1,434,905

 3963 Sq Ft

 5 Beds

 4.5 Baths

 3 Car Garage

 2.0 Story

Fall Into Savings with \$50K incentive through September 30th! Customize your home buying journey - use it towards low rates, appliances, closing costs and more! This list price reflects the \$50,000 incentive being deducted from the price. In addition, Seller will pay \$25,000 towards closing costs! NEW CONSTRUCTION IN NORTHVIEW HIGH SCHOOL DISTRICT! BRAND NEW, 4 SIDES BRICK, 3 CAR GARAGE, GUEST SUITE ON THE MAIN LEVEL, SUNROOM & SO MUCH MORE; Knollwood is a quiet boutique community in the heart of Johns Creek offering 20 homes, THIS IS THE FINAL HOME, DO NOT MISS THIS INCREDIBLE OPPORTUNITY ON A WONDERFUL HOMESITE BESIDE OPEN GREEN SPACE. "THE MATHEWS" IS ONE OF THE MOST REQUESTED HOMES OFFERED BY AWARD WINNING THE PROVIDENCE GROUP. THIS AMAZING HOME WILL BE COMPLETED AND READY FOR YOUR QUICK MOVE IN. SO MUCH TO LOVE IN THIS HOME; A STUDY ON THE MAIN, GUEST ROOM WITH PRIVATE FULL BATH, A SEPERATE POWDER ROOM FOR GUESTS, THE OPEN CONCEPT ON THE MAIN LEVEL IS A FAN FAVORITE, A STUNNING KITCHEN WITH CABINETS TO THE CEILING, POT & PAN DRAWERS, 5 BURNER GAS COOKTOP, DOUBLE WALL OVENS, WOOD VENT HOOD VENTED TO THE OUTSIDE, WINE REFRIGERATOR, BEAUTIFUL LARGE ...

**Want to Know More
About This Home?**

CONTACT OUR COMMUNITY SALES MANAGER
Call Us @ 678.424.6275



FIRST FLOOR

Elevation A

Want to Know More
About This Home?

CONTACT OUR COMMUNITY SALES MANAGER
Call Us @ 678.424.6275



SECOND FLOOR

Elevation A

Want to Know More
About This Home?

CONTACT OUR COMMUNITY SALES MANAGER
Call Us @ 678.424.6275

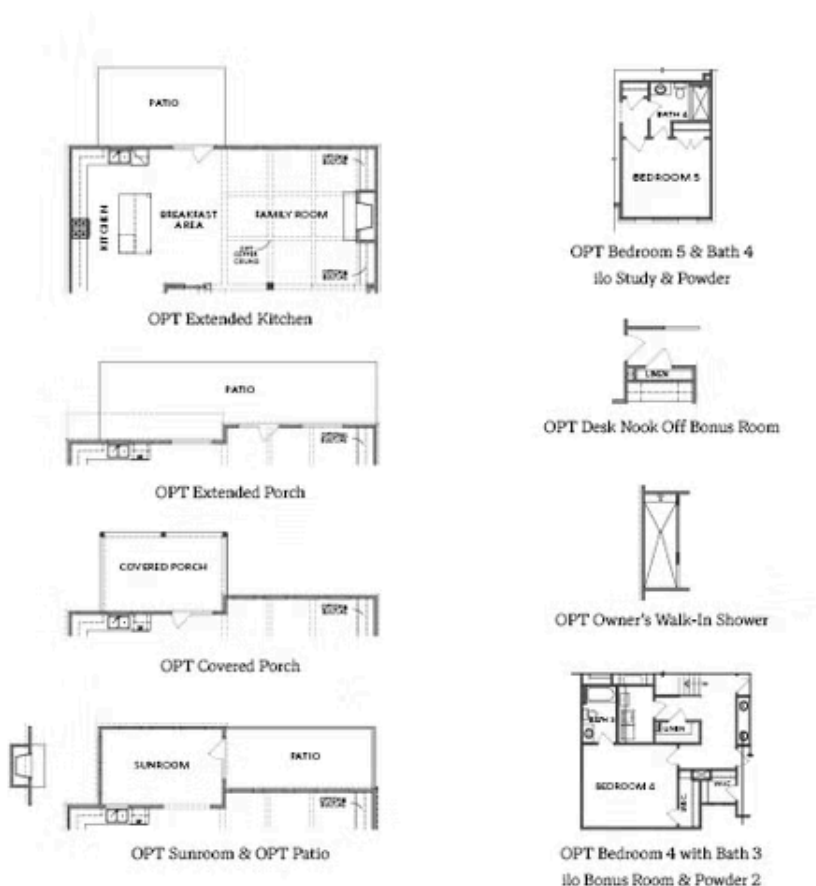

OPTIONS

Want to Know More
About This Home?

CONTACT OUR COMMUNITY SALES MANAGER
Call Us @ 678.424.6275



OPT Bedroom 7 and Full Bath 6 with Bonus Room Layout

OPTIONS

Want to Know More
About This Home?

CONTACT OUR COMMUNITY SALES MANAGER
Call Us @ 678.424.6275



OPT Bedroom 7 and Full Bath 6 with Bedroom 4 Layout

OPTIONS

Want to Know More
About This Home?

CONTACT OUR COMMUNITY SALES MANAGER
Call Us @ 678.424.6275