



PRICED AT
\$1,228,415

 **3163 Sq Ft**

 **5 Beds**

 **4.0 Baths**

 **2 Car Garage**

 **2.0 Story**

NEW CONSTRUCTION SINGLE FAMILY IN NORTHVIEW HIGH SCHOOL!! ALL PHOTOS/RENDERINGS ARE OF SAME PLAN BUT NOT ACTUAL HOME. MAKE AN APPOINTMENT TODAY TO TOUR THIS BEAUTIFUL COMMUNITY OF NEW HOMES, PROFESSIONAL DESIGN SELECTIONS HAVE BEEN SELECTED FOR THIS HOME; STACKED CABINETS TO THE CEILING IN THE KITCHEN, QUARTZ WATERFALL ISLAND, FARM SINK, HARD SURFACE THROUGH OUT THE ENTIRE HOME, LINEAR FIREPLACE WITH BUILT INS, ALL FRAMELESS SHOWER ENCLOSURES, BEAUTIFUL CHAMPAGNE BRONZE FIXTURES, GE CAFE APPLIANCES.... The Cannady home design offers an amazing open concept with tons of natural light with 7' tall windows all the way across the back wall of the home. This Open Concept home design flows effortlessly for every day living and perfect for entertaining! A spacious kitchen with tons of cabinets, a wonderful island and walk in pantry makes all of your meal prep and entertaining enjoyable, open to both the family room and large dining room! Guest suite with full bath on the main, adjacent to a separate outdoor entrance. The second floor offers 4 bedrooms and 3 full baths; The owners retreat has beautiful natural light streaming in through wonderful windows, a relaxing spa like bath with a large walk in closet. 1 secondary ...

**Want to Know More
About This Home?**

CONTACT OUR COMMUNITY SALES MANAGER
Call Us @ 678.424.6275

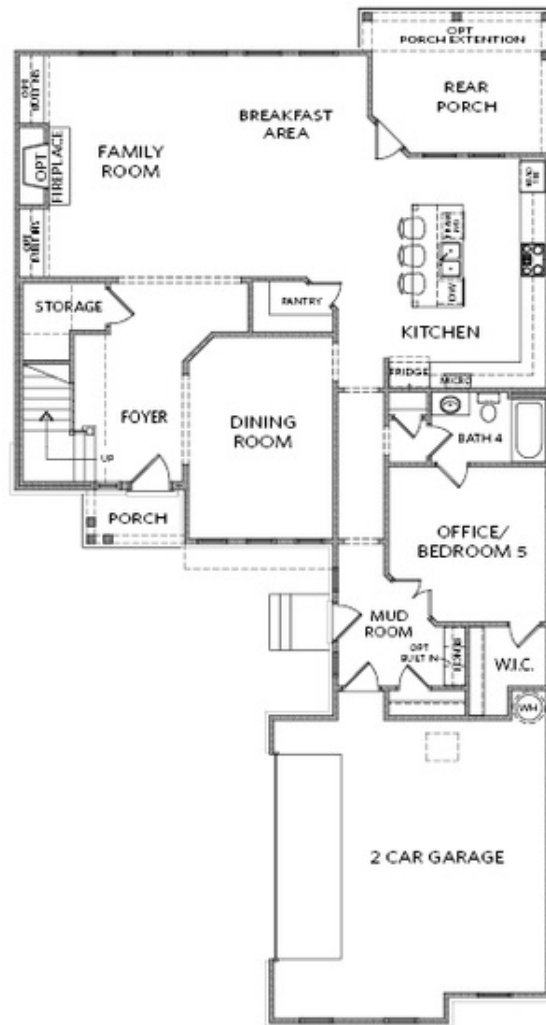

FIRST FLOOR

Elevation A

Want to Know More
About This Home?

CONTACT OUR COMMUNITY SALES MANAGER
Call Us @ 678.424.6275



SECOND FLOOR

Elevation A

Want to Know More
About This Home?

CONTACT OUR COMMUNITY SALES MANAGER
Call Us @ 678.424.6275