



PRICED AT
\$684,850

 2400 Sq Ft

 4 Beds

 3.5 Baths

 2 Car Garage

 3.0 Story

PICK YOUR PROMOTION \$10k! Choose the path to homeownership that fits your life - with low rates, upgrades, appliances, closing costs, and more. Offer ends July 31st, 2025. Welcome to the brand new Benton III floorplan at Ward's Crossing in Johns Creek! This beautiful 4-bedroom design features 2400 square feet of living space on three levels. This is a presale opportunity so design selections can still be made by the purchaser! Sales price includes the base price of the home, lot premium and all structural options including terrace level walk in shower, Huge walk in shower with drying area in the primary bathroom and a linear fireplace. As you enter the first level front door of the home you will have your first full bedroom which makes for perfect office or guest bedroom. Upstairs you will find a beautiful open design featuring 10 ft. ceilings and a gorgeous chef's kitchen with tons of cabinets, walk in pantry and GE Profile appliances. The spacious family room features a beautiful linear gas fireplace. A laundry room is located on this level in addition to a beautiful sunroom that walks out onto a beautiful deck. Tons of light fills this main level with ...

**Want to Know More
About This Home?**

CONTACT OUR COMMUNITY SALES MANAGER
Call Us @ 770.521.2151



Elevation S2

Want to Know More
About This Home?

CONTACT OUR COMMUNITY SALES MANAGER
Call Us @ 770.521.2151



Elevation S2

Want to Know More
About This Home?

CONTACT OUR COMMUNITY SALES MANAGER
Call Us @ 770.521.2151



Elevation S2

Want to Know More
About This Home?

CONTACT OUR COMMUNITY SALES MANAGER
Call Us @ 770.521.2151

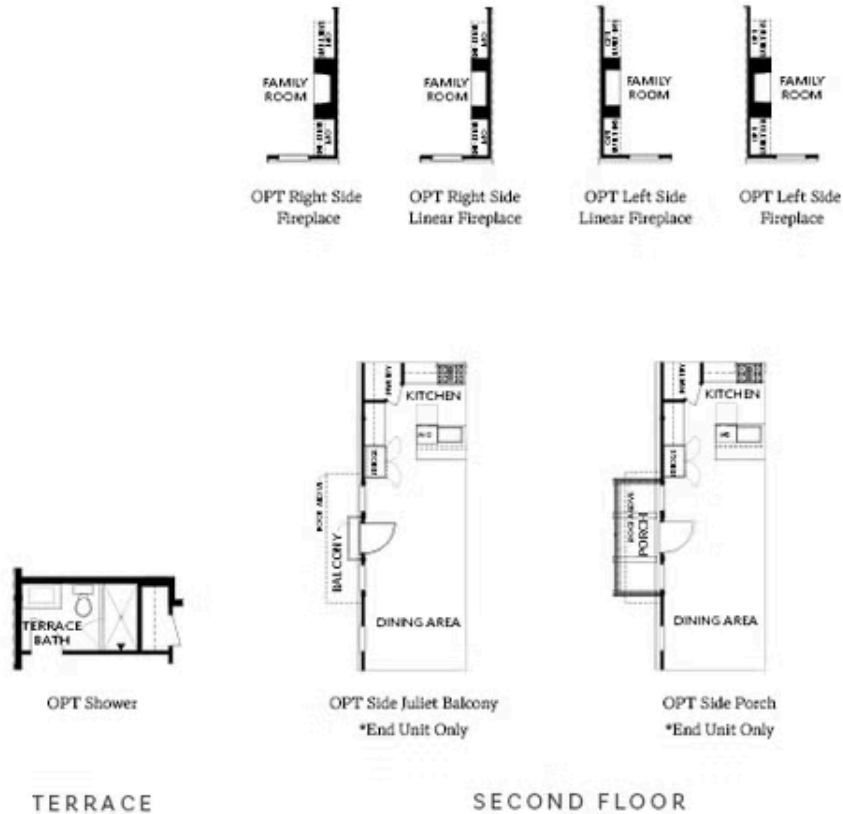

Want to Know More
About This Home?

CONTACT OUR COMMUNITY SALES MANAGER
Call Us @ 770.521.2151

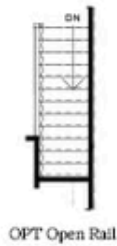

Want to Know More
About This Home?

CONTACT OUR COMMUNITY SALES MANAGER
Call Us @ 770.521.2151