



PRICED AT
\$674,900

 2520 Sq Ft

 3 Beds

 2.0 Baths

 1 Car Garage

 1.0 Story

Sizzling Summer Savings! SINGLE LEVEL LIVING in our Exclusive Waterside Community! Introducing Phase II - OUR SOLD OUT CONDO FLOORPLANS ARE BACK! Massive 3-Bedroom floor plan. Open concept throughout the home with WOW factor 10ft Ceilings. Dining room flows into a luxury kitchen with Quartz Countertops and an upgraded GE Profile Appliance Package. Room for several barstools on the island, kitchen leads into living room and out to exquisite, covered Porch. Enduring Grey design package with accented island, durable floors and painted doors! Owner's Retreat with sitting room in Owners' Bedroom, Large Closet, Freestanding Tub. Door directly to garage inside unit, resident gets use of driveway behind their garage as well! Resort-Style Amenity package open for Homeowner use - massive clubhouse with a fitness center, 4 pickleball courts, multiple fire pit areas, a pool with a pool deck looking out into the River and 3 green lawn spaces, HOA-maintained lawns, and a manned gate at the entrance. Amenities make meeting your neighbors and friends easy. Photos do not represent the actual home. At TPG, we value our customer, team member, and vendor team safety. Our communities are active construction zones and may not be safe to visit at certain stages ...

**Want to Know More
About This Home?**

CONTACT OUR COMMUNITY SALES MANAGER
Call Us @ 470.514.6999



FIRST FLOOR

Want to Know More
About This Home?

CONTACT OUR COMMUNITY SALES MANAGER
Call Us @ 470.514.6999



SECOND FLOOR - LEFT END UNIT

Want to Know More
About This Home?

CONTACT OUR COMMUNITY SALES MANAGER
Call Us @ 470.514.6999



SECOND FLOOR - RIGHT END UNIT

Want to Know More
About This Home?

CONTACT OUR COMMUNITY SALES MANAGER
Call Us @ 470.514.6999

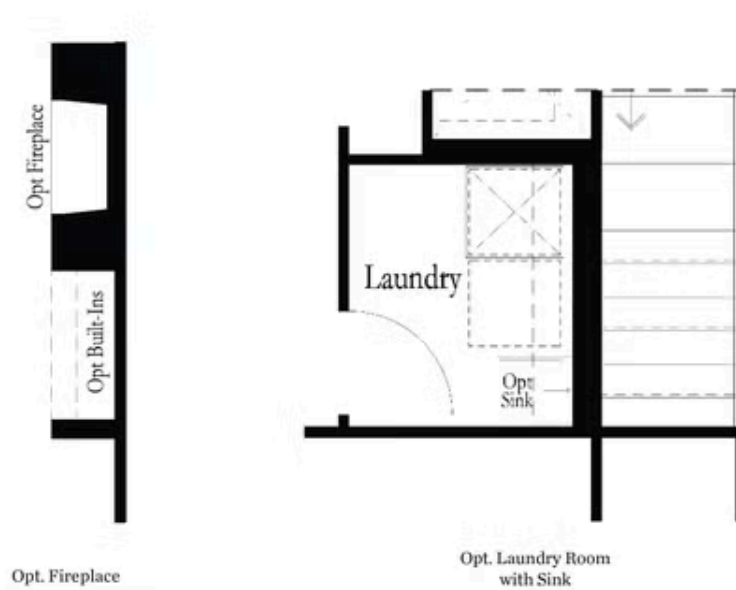

Want to Know More
About This Home?

CONTACT OUR COMMUNITY SALES MANAGER
Call Us @ 470.514.6999