



PRICED AT
\$682,900

 2350 Sq Ft

 3 Beds

 2.0 Baths

 1 Car Garage

 1.0 Story

Summer of Savings with a New Home of The Providence Group! \$5,000 towards closing cost when financing with one of our preferred lenders. Be impressed with the three bedroom Cochran condo plan, end unit! You will love this one level living! Still time to secure this beautiful home and pick your design package! This home will have extra windows in the Owners suite making your retreat beam with natural light. The kitchen has a warm, inviting feel, blending natural and neutral tones with subtle elegance. The cabinets create a soft, timeless look, pairing beautifully with island, which adds an textured contrast. The fixtures, including the stainless faucet and cabinet handles, add a hint of luxury without overwhelming the neutral palette. They have a soft, two-tone finish that feels modern yet understated, tying in with the warmth of the room. The floors can be finished in a Ryman color, a light, neutral wood tone that gives the kitchen an airy, expansive feel, complementing the cabinets and bringing a cohesive flow to the space. White walls provide a crisp backdrop, making the room feel spacious and bright. The open-concept design seamlessly connects the kitchen to the family room, allowing for easy flow ...

**Want to Know More
About This Home?**

CONTACT OUR COMMUNITY SALES MANAGER
Call Us @ 470.514.6999



FIRST FLOOR

Want to Know More
About This Home?

CONTACT OUR COMMUNITY SALES MANAGER
Call Us @ 470.514.6999



SECOND FLOOR - LEFT END UNIT

Want to Know More
About This Home?

CONTACT OUR COMMUNITY SALES MANAGER
Call Us @ 470.514.6999



SECOND FLOOR - RIGHT END UNIT

Want to Know More
About This Home?

CONTACT OUR COMMUNITY SALES MANAGER
Call Us @ 470.514.6999

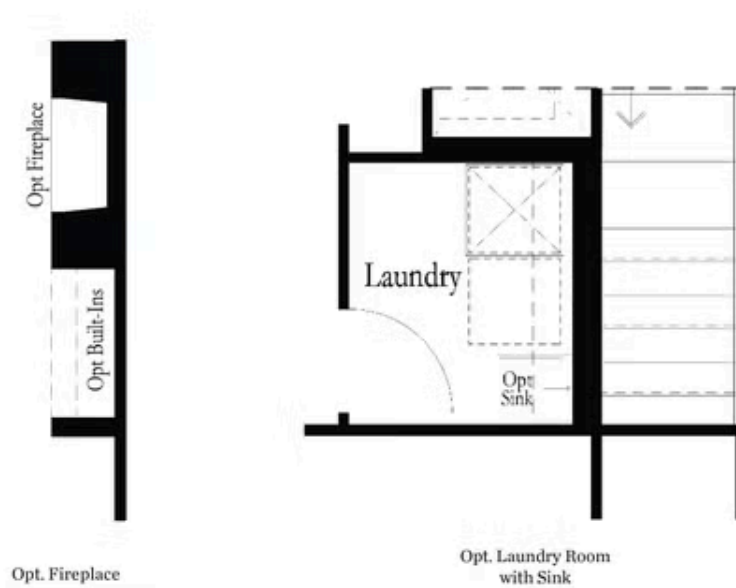

Want to Know More
About This Home?

CONTACT OUR COMMUNITY SALES MANAGER
Call Us @ 470.514.6999