



PRICED AT
\$695,900

 2350 Sq Ft

 3 Beds

 2.0 Baths

 1 Car Garage

 1.0 Story

Spring into a New Home with The Providence Group! \$5,000 towards closing cost when financing with one of our preferred lenders. Be impressed with the three bedroom Cochran condo plan, end unit! You will love this one level living! This home will have extra windows in the Owners suite making your retreat beam with natural light. The kitchen has a warm, inviting feel, blending natural and neutral tones with subtle elegance. The beige cabinets create a soft, timeless look, pairing beautifully with the driftwood island, which adds an earthy, textured contrast. The island has a light, weathered gray-brown hue reminiscent of natural driftwood, grounding the space with an organic, rustic element. The champagne fixtures, including the faucet and cabinet handles, add a hint of luxury without overwhelming the neutral palette. They have a soft, gold-tone finish that feels modern yet understated, tying in with the warmth of the room. The floors are finished in a Ryman color, a light, neutral wood tone that gives the kitchen an airy, expansive feel, complementing the cabinets and bringing a cohesive flow to the space. Alabaster walls provide a crisp yet warm backdrop, making the room feel spacious and bright without the starkness of ...

**Want to Know More
About This Home?**

CONTACT OUR COMMUNITY SALES MANAGER
Call Us @ 470.514.6999



FIRST FLOOR

Want to Know More
About This Home?

CONTACT OUR COMMUNITY SALES MANAGER
Call Us @ 470.514.6999



SECOND FLOOR - LEFT END UNIT

Want to Know More
About This Home?

CONTACT OUR COMMUNITY SALES MANAGER
Call Us @ 470.514.6999



SECOND FLOOR - RIGHT END UNIT

Want to Know More
About This Home?

CONTACT OUR COMMUNITY SALES MANAGER
Call Us @ 470.514.6999

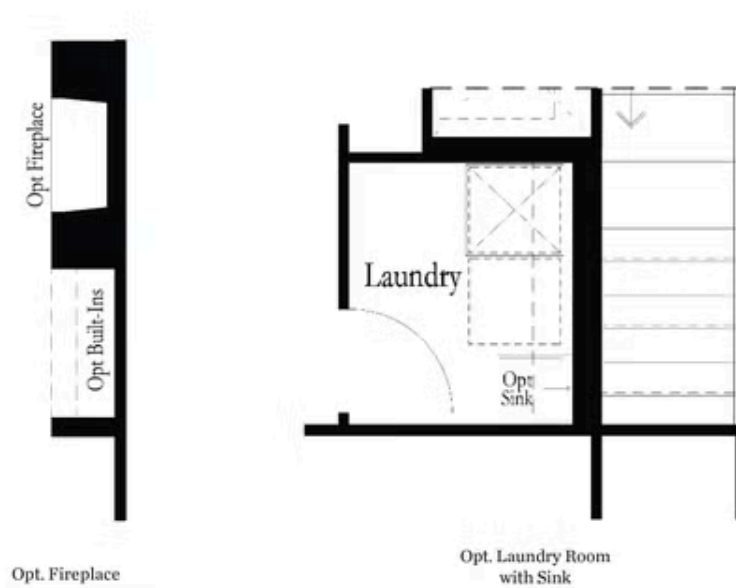

Want to Know More
About This Home?

CONTACT OUR COMMUNITY SALES MANAGER
Call Us @ 470.514.6999