



PRICED AT
\$740,985

 **2201 Sq Ft**

 **3 Beds**

 **2.5 Baths**

 **2 Car Garage**

 **3.0 Story**

New Year, New Home, New You! \$20K YOUR WAY for contracts closing by the end of February! Looking for a townhome with a FENCED IN YARD & OUTDOOR FIREPLACE? Introducing this Benton 1 END UNIT! All yardwork in yard is taken care of by the HOA. Inside the front door of the home, you will find multi-use flex room that could fit many needs (gym, office, extra living space). Upstairs on main level you will find the kitchen, living and dining areas - all complete with upgraded finishes throughout. White cabinets with upgraded GE Cafe Appliances. Ceramic farmhouse sink sits underneath glass pendant lights to create the perfect contrast of bright and elegant! Natural shades throughout, beautiful Shaw flooring with warm undertones. Design upgraded continue throughout with Matte Black hardware, 36" Fireplace with white painted brick surround and Rheem tankless water heater. Large windows adorn the living room for tons of natural light! Tucked away behind the kitchen is a sunroom that could double as a home office space with access to the deck. White upper cabinets included in laundry for storage! The top floor hosts your spacious owner's suite with large walk-in closet. No carpet in any of the ...

**Want to Know More
About This Home?**

**CONTACT OUR COMMUNITY SALES MANAGER
Call Us @ 470.514.6999**

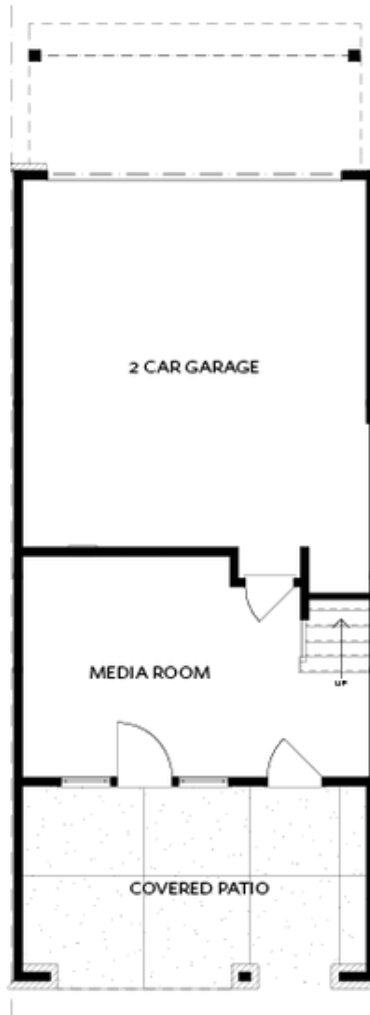

TERRACE

Elevation N

Want to Know More
About This Home?

CONTACT OUR COMMUNITY SALES MANAGER
Call Us @ 470.514.6999

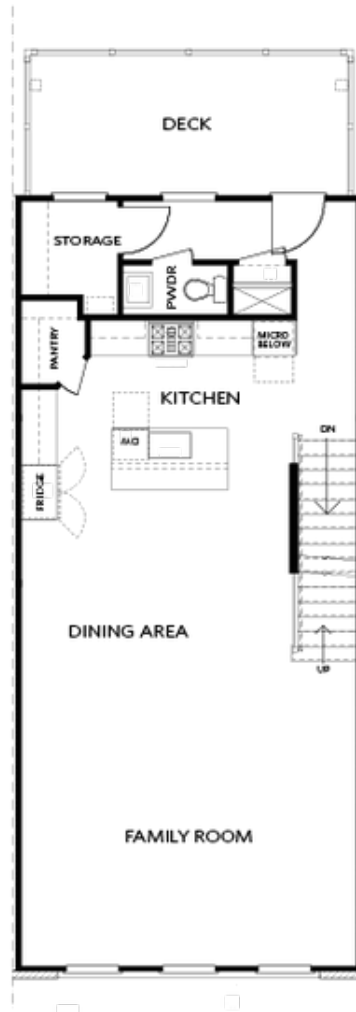

SECOND FLOOR

Elevation N

Want to Know More
About This Home?

CONTACT OUR COMMUNITY SALES MANAGER
Call Us @ 470.514.6999

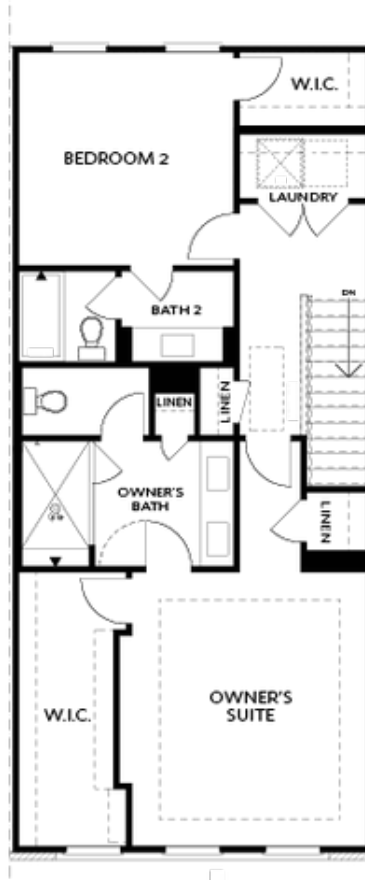

THIRD FLOOR

Elevation N

Want to Know More
About This Home?

CONTACT OUR COMMUNITY SALES MANAGER
Call Us @ 470.514.6999



OPT Patio Fireplace



OPT Laundry
(only available with 3rd bedroom opt)



OPT Left Side
Linear Fireplace



OPT Left Side
Fireplace



OPT Right Side
Fireplace



OPT Right Side
Linear Fireplace

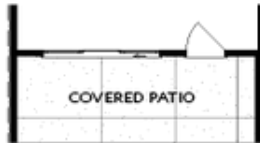

OPT Slider Door

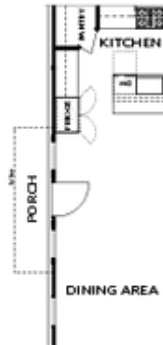

OPT Side Porch
(end unit only)



OPT Sunroom

TERRACE

SECOND FLOOR

OPTIONS

Want to Know More
About This Home?

CONTACT OUR COMMUNITY SALES MANAGER
Call Us @ 470.514.6999

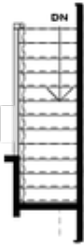

OPT Open Rail



OPT Bedroom 3 - ONLY Available with Optional Sunroom



OPT Walk-Through Shower

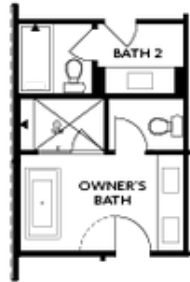

OPT Freestanding Tub/Shower Combo



OPT Decked Tub/Shower Combo

OPTIONS

Want to Know More
 About This Home?

CONTACT OUR COMMUNITY SALES MANAGER
 Call Us @ 470.514.6999