



PRICED AT  
**\$432,900**

 1903 Sq Ft

 3 Beds

 3.5 Baths

 2 Car Garage

 3.0 Story

Glendale J1 - Come see what's new in Scottdale! Gated community w/ dog park & pocket park. This home is an end unit with a sunroom, open floor plan & lots of natural light. 3 BR, 3.5 BA, large kitchen w/ ample kitchen island space, open to the living area. Owner's suite features a large bedroom, walk-in closet & gorgeous bathroom w/ separate soaking tub and large glass shower. Fireplaces are an option. All bedrooms have ensuite baths. Great ITP location! 4 mi to Decatur Square, 2 mi from Dekalb Farmer's market, 1/2 mi to I-285 Under construction. Furnished Pictures = Model home

**Want to Know More  
About This Home?**

CONTACT OUR COMMUNITY SALES MANAGER  
Call Us @ (678) 628-9173



TERRACE

Elevations B & C Floor Plan Layout

**Want to Know More  
About This Home?**

CONTACT OUR COMMUNITY SALES MANAGER  
Call Us @ (678) 628-9173



FIRST FLOOR

Elevations B & C Floor Plan Layout

**Want to Know More  
About This Home?**

CONTACT OUR COMMUNITY SALES MANAGER  
Call Us @ (678) 628-9173

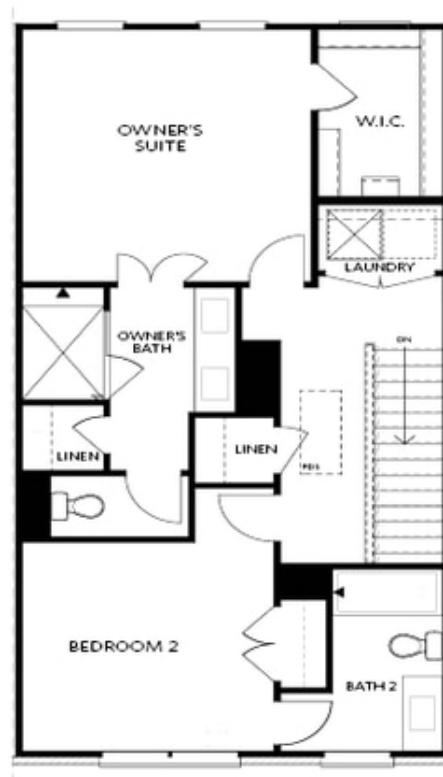

**SECOND FLOOR**

Elevations B & C Floor Plan Layout

**Want to Know More  
About This Home?**

CONTACT OUR COMMUNITY SALES MANAGER  
Call Us @ (678) 628-9173

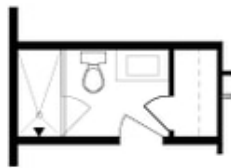

OPT Bath 3 Shower ilo  
Tub/Shower Combo



OPT Sunroom ilo Full Deck



OPT Owner's  
Walk-Through Shower

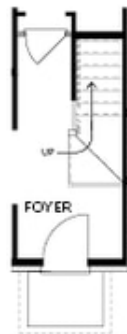

OPT Stair Landing  
on Terrace



OPT Fireplace



OPT Linear Fireplace



OPT Owner's Shower &  
Tub Combo

## OPTIONS

Want to Know More  
About This Home?

CONTACT OUR COMMUNITY SALES MANAGER  
Call Us @ (678) 628-9173