



PRICED AT
\$586,800

 2004 Sq Ft

 3 Beds

 3.5 Baths

 2 Car Garage

 3.0 Story

Introducing the End Unit Glendale - crafted by The Providence Group at Ellington! This sought-after layout presents a secluded bedroom on the entry level, complete with a full Bath for added convenience. The second floor epitomizes open-concept living, featuring a luminous Kitchen adorned with polished floors, an expansive Quartz Island, and stainless steel appliances. It seamlessly flows into the Dining and Family Rooms, extending to a sunlit sunroom and deck - ideal for hosting gatherings! Upstairs, retreat to your Owner Suite boasting a spacious Walk-in Closet and a luxurious Spa-like Bath, complete with a walk-in Shower, soaking Tub, and separate vanities. The laundry area is conveniently positioned on the same level as the primary bedroom. Additionally, both secondary bedrooms offer full baths, accommodating work-from-home office space or multi-generational living. Community amenities include a gated entrance, clubhouse, pool, five pocket parks, and a paved walkway leading to Peachtree Ridge Park! With top-rated Schools, Shopping, Dining, Parks, and Trails nearby, this location offers unparalleled convenience. This home is to be built, allowing you to personalize your New Providence Group Home by selecting interior finishes prior to framing start. Begin your exciting journey to Ellington today by stopping by! Please note, photos depict ...

**Want to Know More
About This Home?**

CONTACT OUR COMMUNITY SALES MANAGER
Call Us @ 470.456.9551



**Want to Know More
About This Home?**

CONTACT OUR COMMUNITY SALES MANAGER
Call Us @ 470.456.9551

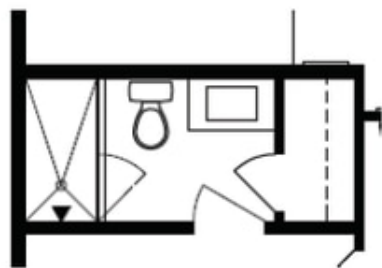

Optional Bath 3 Shower ilo Tub



Optional Owner's Luxury Shower

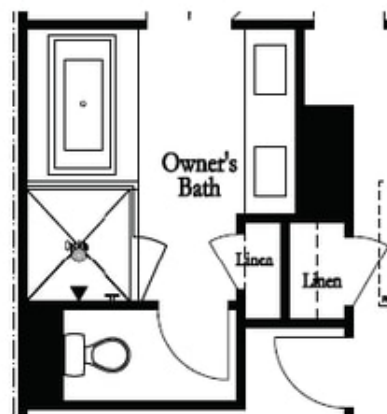

Optional Owner's Shower & Tub

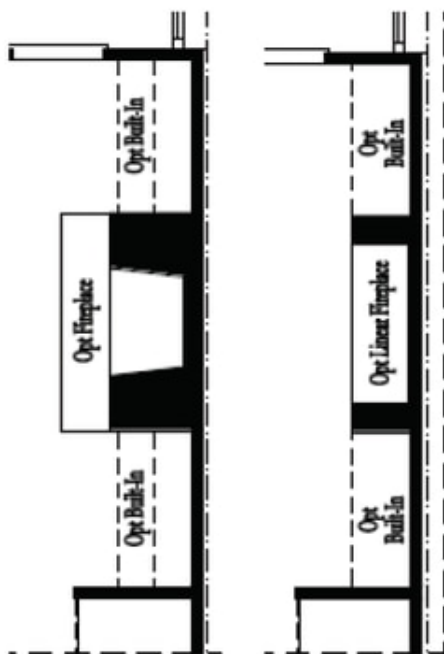

Optional
Family Room
Fireplace

Optional
Family Room
Linear Fireplace

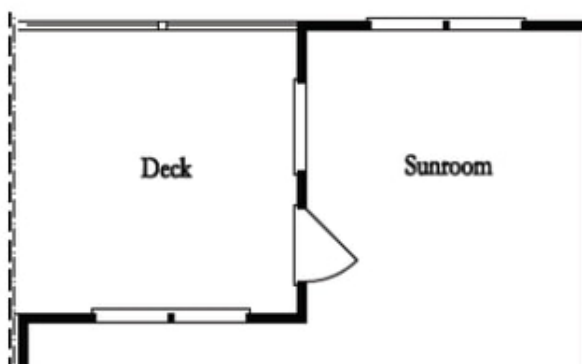

Optional Sunroom 1 ilo Extended Deck

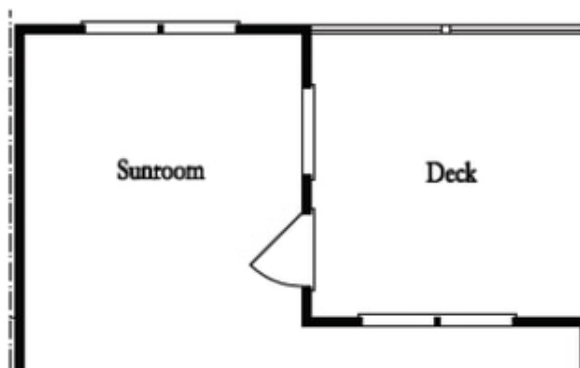

Optional Sunroom 2 ilo Extended Deck

**Want to Know More
About This Home?**

CONTACT OUR COMMUNITY SALES MANAGER
Call Us @ 470.456.9551