



PRICED FROM  
**\$542,400**

 1,893 - 2,004 Sq Ft

 3 Beds

 3.5 Baths

 2 Car Garage

 3.0 Story

- Spacious Three Story Design with Open Main Level Layout
- Gourmet Kitchen with Island overlooking Dining and Family Room
- Owner's Suite and Private Bath with Dual Vanities and Over Size Walk-In Closet on Upper Level
- A Secondary Bedroom and Laundry on Upper Level
- Two Car Garage

[Read More Online](#)

## Available Elevations

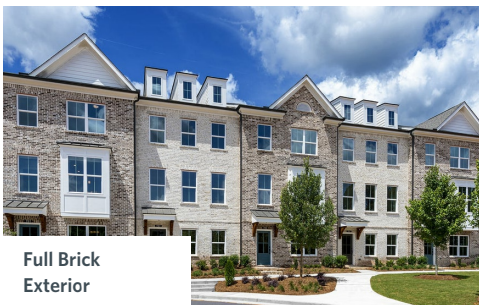



TERRACE

Elevations B & C Floor Plan Layout

**Want to Know More  
About This Home?**

CONTACT OUR COMMUNITY SALES MANAGER  
Call Us @ 470.456.9551



FIRST FLOOR

Elevations B & C Floor Plan Layout

**Want to Know More  
About This Home?**

CONTACT OUR COMMUNITY SALES MANAGER  
Call Us @ 470.456.9551

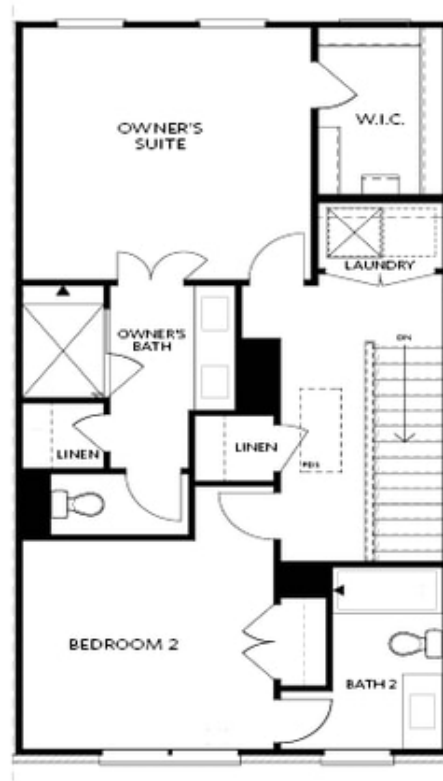

SECOND FLOOR

Elevations B & C Floor Plan Layout

**Want to Know More  
About This Home?**

CONTACT OUR COMMUNITY SALES MANAGER  
Call Us @ 470.456.9551

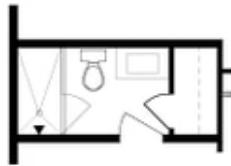

OPT Bath 3 Shower ilo  
Tub/Shower Combo



OPT Sunroom ilo Full Deck



OPT Owner's  
Walk-Through Shower

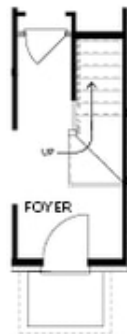

OPT Stair Landing  
on Terrace



OPT Fireplace



OPT Linear Fireplace



OPT Owner's Shower &  
Tub Combo

## OPTIONS

Want to Know More  
About This Home?

CONTACT OUR COMMUNITY SALES MANAGER  
Call Us @ 470.456.9551