



PRICED FROM
\$557,900

 2,036 - 2,042 Sq Ft

 3 - 4 Beds

 2.5 - 3 Baths

 2 Car Garage

 2.0 - 3.0 Story

- Open Main Level with Large Kitchen with Island Overlooking Dining Room, Family Room and Outdoor Living
- Optional Layouts for Owner's Suite
- Owner's Suite with Spacious Bath with Corner Tub, Separate Shower, Separate Vanities and Huge Walk-In Closets
- Secondary Bedrooms Feature Walk-In Closets
- Upper Level Laundry Room

[Read More Online](#)

Available Elevations





Unfinished Basement

Want to Know More
About This Home?

CONTACT OUR COMMUNITY SALES MANAGER
Call Us @ 470.456.9551



First Floor

Want to Know More
About This Home?

CONTACT OUR COMMUNITY SALES MANAGER
Call Us @ 470.456.9551



Second Floor
(Owner's Front)

Elevations G, H, J1, J3 & L

Want to Know More
About This Home?

CONTACT OUR COMMUNITY SALES MANAGER
Call Us @ 470.456.9551



Second Floor
(Owner's Rear)

Elevations G, H, J1, J3 & L

Want to Know More
About This Home?

CONTACT OUR COMMUNITY SALES MANAGER
Call Us @ 470.456.9551



Opt. Screened Patio



Opt. Coverd Patio



Opt. Linear Fireplace



Opt. Fireplace



Opt. 8 Foot Slider Door



Opt. 12 Foot Slider Door

Main Level Options

Want to Know More
About This Home?

CONTACT OUR COMMUNITY SALES MANAGER
Call Us @ 470.456.9551

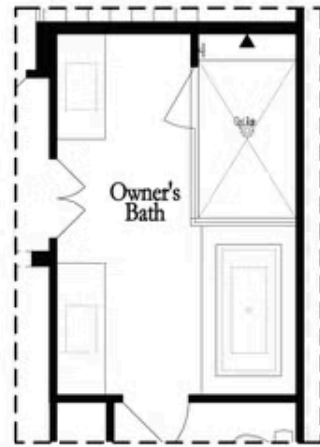

Opt. Shower/Tub



Opt. Walk-Through Shower

Owner's Front - Options

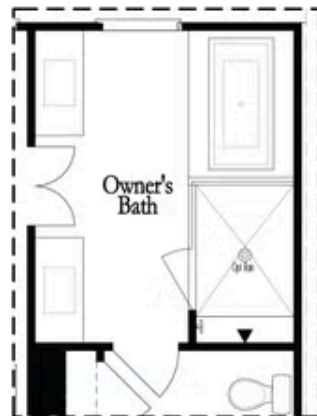

Opt. Shower/Tub



Opt. Walk-Through Shower

Owner's Rear - Options

Want to Know More
About This Home?

CONTACT OUR COMMUNITY SALES MANAGER
Call Us @ 470.456.9551