



PRICED AT  
**\$567,982**

 1893 Sq Ft

 3 Beds

 3.5 Baths

 2 Car Garage

 3.0 Story

**Sizzling Summer Savings! Discover the Last Opportunity to Acquire the Signature Garwood Home Design in Ellington's Model Home! Crafted by The Providence Group Homes, this new construction masterpiece boasts a captivating exterior featuring a brick front and a 2-car garage. Upon entry through the mid-level foyer, encounter the exquisitely designed kitchen, showcasing an expansive island complemented by quartz countertops, stainless steel appliances, and a tile backsplash. The seamless open-concept layout connects the kitchen to the family room and dining area, ideal for modern living. Step onto the generous rear deck for outdoor gatherings. Retreat upstairs to the indulgent owner's suite, offering a lavish bathroom with a dual vanity and an large walk-in shower. Another bedroom with a private bath awaits down the hallway, with the convenience of the laundry area situated on the upper floor. The terrace level presents a bedroom and full bath alongside the 2-car garage. Visit our fully furnished Garwood Model Home today! Ellington's amenities include a gated entrance, clubhouse, pool, playground, five pocket parks, and paved access to County Park Trails and a pathway leading to Peachtree Ridge Park! At TPG, we value our customer, team member, and vendor team safety. Our communities are active construction ...**

**Want to Know More  
About This Home?**

CONTACT OUR COMMUNITY SALES MANAGER  
Call Us @ 470.456.9551



**Want to Know More  
About This Home?**

CONTACT OUR COMMUNITY SALES MANAGER  
Call Us @ 470.456.9551

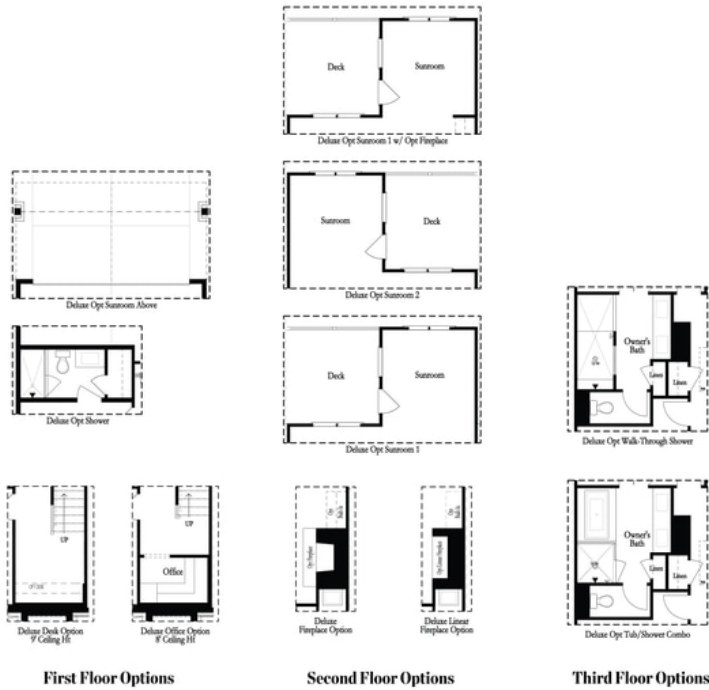

**Want to Know More  
 About This Home?**

CONTACT OUR COMMUNITY SALES MANAGER  
 Call Us @ 470.456.9551