



PRICED AT
\$769,915

 3922 Sq Ft

 5 Beds

 4.5 Baths

 2 Car Garage

 3.0 Story

Calhoun A - Located on a cul-de-sac, this open floor plan is perfect for entertaining & features a family room, breakfast room, separate dining room & beautiful gourmet kitchen. The kitchen offers a large island with a stainless farmsink, stainless appliances & quartz countertops. The owners suite suite is located on the 2nd floor & has his/hers closets, dual vanities in the owners bath & a large, frameless shower. 2 additional bedrooms with private baths & a media room. 3rd floor bonus room & private bedroom/bath. Community Amenities will include a gated entrance, cabana, pool, five pocket parks and access to County park trails and a path to Peachtree Ridge Park. Ellington is located within the desirable Peachtree Ridge School District and just a short 3 mile drive from the award winning Suwanee Towne Center! Home under construction. Estimated closing time frame is Oct/Nov. Pictures are same floorplan but NOT actual home.

**Want to Know More
About This Home?**

CONTACT OUR COMMUNITY SALES MANAGER
Call Us @ 470.456.9551



**Want to Know More
About This Home?**

CONTACT OUR COMMUNITY SALES MANAGER
Call Us @ 470.456.9551



**Want to Know More
About This Home?**

CONTACT OUR COMMUNITY SALES MANAGER
Call Us @ 470.456.9551



Want to Know More
About This Home?

CONTACT OUR COMMUNITY SALES MANAGER
Call Us @ 470.456.9551

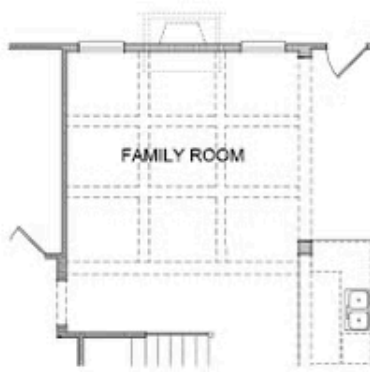

Opt. Coffered Ceilings
w/ Opt. Media Room or Bedroom 5 above



Opt. Bedroom 4 w/ Full Bath
No Study & Power Room



Opt. Sunrooms

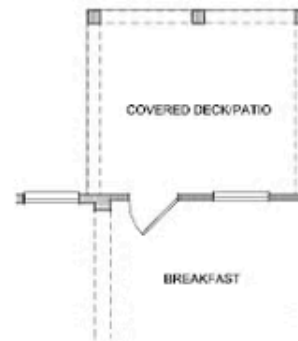

Opt. Covered Deck/Patio

Want to Know More
About This Home?

CONTACT OUR COMMUNITY SALES MANAGER
Call Us @ 470.456.9551



Want to Know More
About This Home?

CONTACT OUR COMMUNITY SALES MANAGER
Call Us @ 470.456.9551