



PRICED AT
\$554,150

 1893 Sq Ft

 3 Beds

 3.5 Baths

 2 Car Garage

 3.0 Story

Don't Miss One of the Last Opportunities to Purchase a Garwood Home Design at Ellington! This New Construction, crafted by The Providence Group Homes, showcases a charming exterior with brick front and a 2-car garage. Step into the mid-level foyer to discover the impeccably designed kitchen boasting an oversized island adorned with quartz countertops, stainless appliances, and tile backsplash! The open-concept layout seamlessly connects the kitchen to the family room and dining area. Relax in the family room, complete with a cozy gas fireplace, and step out onto the spacious rear deck for outdoor entertainment. Upstairs, indulge in the owner's suite featuring a luxurious bathroom with a dual vanity and an extended walk-in shower with a drying area. A secondary bedroom with a private bath awaits down the hallway, with the laundry area conveniently located on the upper floor for easy access. The terrace level offers a bedroom and full bath, alongside the 2-car garage. Explore our fully furnished Garwood Information/Model Home today! Community amenities include a gated entrance, clubhouse, pool, playground, five pocket parks, and paved access to County Park Trails and a pathway leading to Peachtree Ridge Park! This home is completed and ready for you to MOVE-IN! ...

**Want to Know More
About This Home?**

CONTACT OUR COMMUNITY SALES MANAGER
Call Us @ 470.456.9551



**Want to Know More
About This Home?**

CONTACT OUR COMMUNITY SALES MANAGER
Call Us @ 470.456.9551

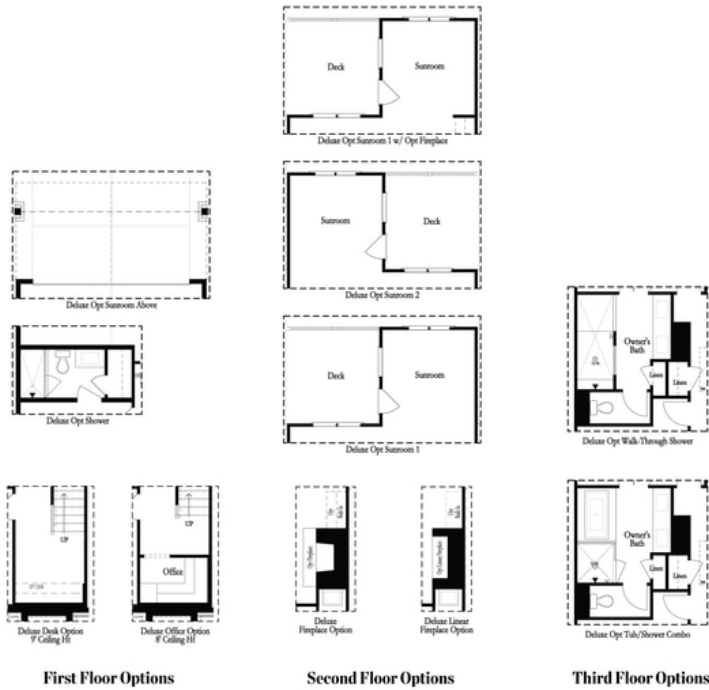

**Want to Know More
 About This Home?**

CONTACT OUR COMMUNITY SALES MANAGER
 Call Us @ 470.456.9551