



PRICED AT  
**\$741,920**

 2468 Sq Ft

 3 Beds

 3.0 Baths

 2 Car Garage

 2.0 Story

**OWNER SUITE ON MAIN!!!** Elevate your Life in 2023! Sought after Bayfield plan with Two Bedrooms including Owner's Bedroom on Main Level! This open layout is perfect for entertaining & features a Family room, Breakfast room, a Sunroom that can be used as separate Dining. Beautiful Gourmet Kitchen with Butler's Pantry, large Island with stainless appliances & quartz countertops. Owners suite is located on the 1st floor with dual vanities in the Owners Spa-like Bath & large walk-in closet. Second Floor has Full Bedroom/Bathroom and Loft/Bonus Room, lots of storage at easily accessible attic. Community Amenities include a gated entrance, club house, pool, five pocket parks, paved walkway to Peachtree Ridge Park. Ellington is located within the desirable Peachtree Ridge School District and just a short 3 mile drive from the award winning Suwanee Towne Center! This home is under construction with Estimated Move-in: November - December 2023.

**Want to Know More  
About This Home?**

CONTACT OUR NEW HOME NAVIGATOR

**NONE**

Call Us @ 470.456.9551



Want to Know More  
About This Home?

CONTACT OUR NEW HOME NAVIGATOR

**NONE**

Call Us @ 470.456.9551

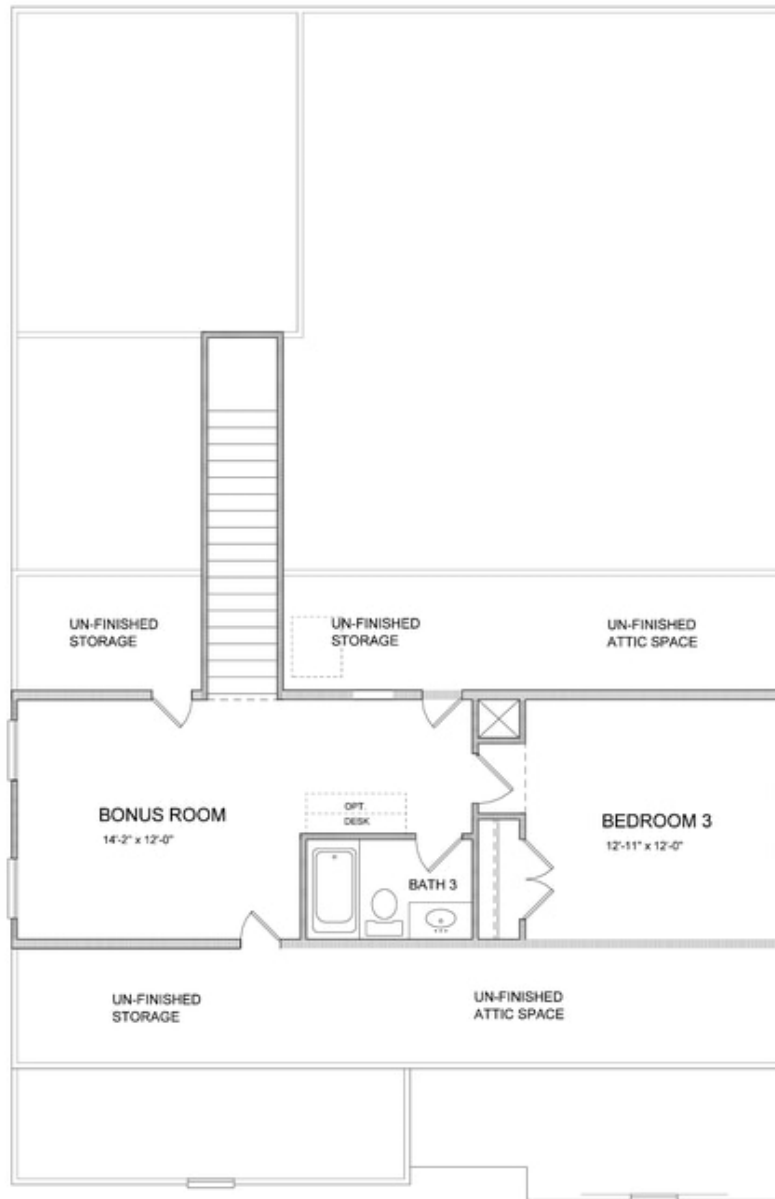

**Want to Know More  
About This Home?**

CONTACT OUR NEW HOME NAVIGATOR

**NONE**

Call Us @ 470.456.9551

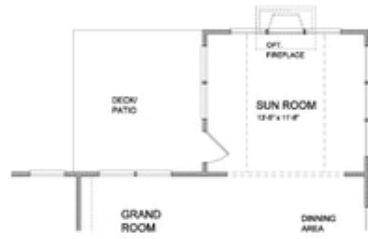

Opt. Sunroom

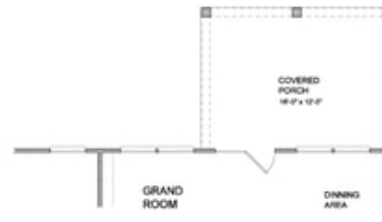

Opt. Covered Porch

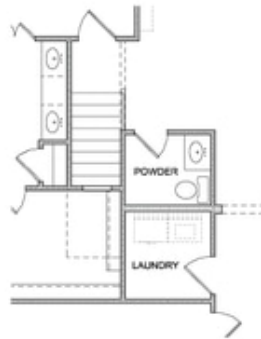

Opt. Powder Room

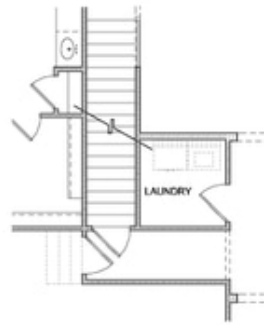

Opt. Laundry Room  
 (with basement)



Opt. Laundry Room  
 (with sink)

OPTIONS - FIRST FLOOR

**Want to Know More  
 About This Home?**

CONTACT OUR NEW HOME NAVIGATOR

**NONE**

Call Us @ 470.456.9551