







PRICED AT
\$875,685

-  3521 Sq Ft
-  4 Beds
-  3.0 Baths
-  2 Car Garage
-  2.0 Story

ELEVATE YOUR LIFE IN 2023! Beautiful white-painted modern farmhouse-style home offering luxurious living with details every buyer desires. Everything you wanted in a home. Open floor plan featuring 10 ft. ceilings. Impressive designer kitchen with a clear view of the family room. Oversized quartz island with plenty of seating for chatting with guests as the chef cooks in the fabulous gourmet kitchen. Featuring a guest suite on the main floor which could also make a convenient home office. Plenty of sizable storage in the unfinished basement also is perfect for one or two more future bedrooms. The second floor offers a large owner's retreat with separate vanities, and deluxe walk-in shower. Two spacious secondary bedrooms with jack & jill bath finish out the second floor. HOA maintained homesites. Estimated closing time frame is March/April 2023. Walking distance to Suwanee Town Center, the Greenway trails, restaurants, shops, and so much more. Top North Gwinnett schools. To be built - Photos are not actual home. Photos of similar previously built home.

Want to Know More
About This Home?

CONTACT OUR COMMUNITY SALES MANAGER
NONE
Call Us @ (678) 332-7300

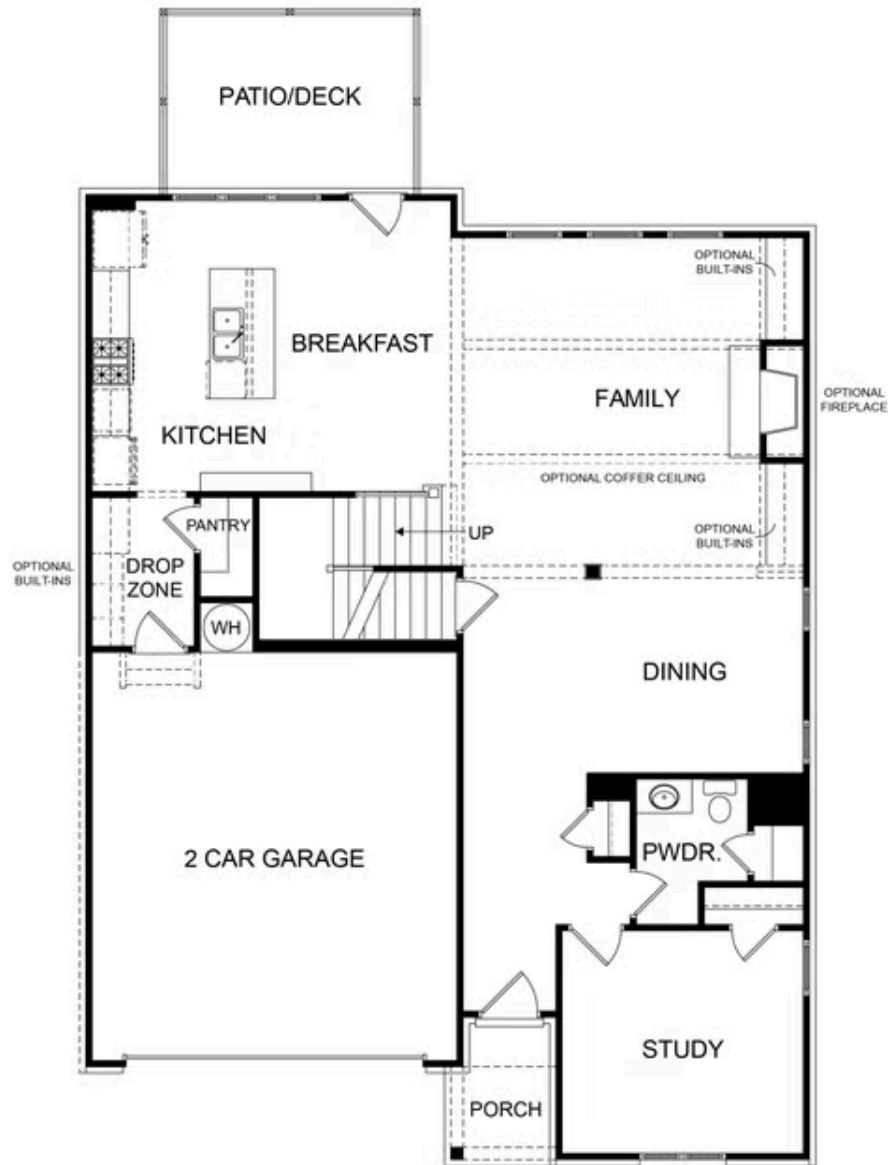

Want to Know More
About This Home?

CONTACT OUR COMMUNITY SALES MANAGER

NONE

Call Us @ (678) 332-7300

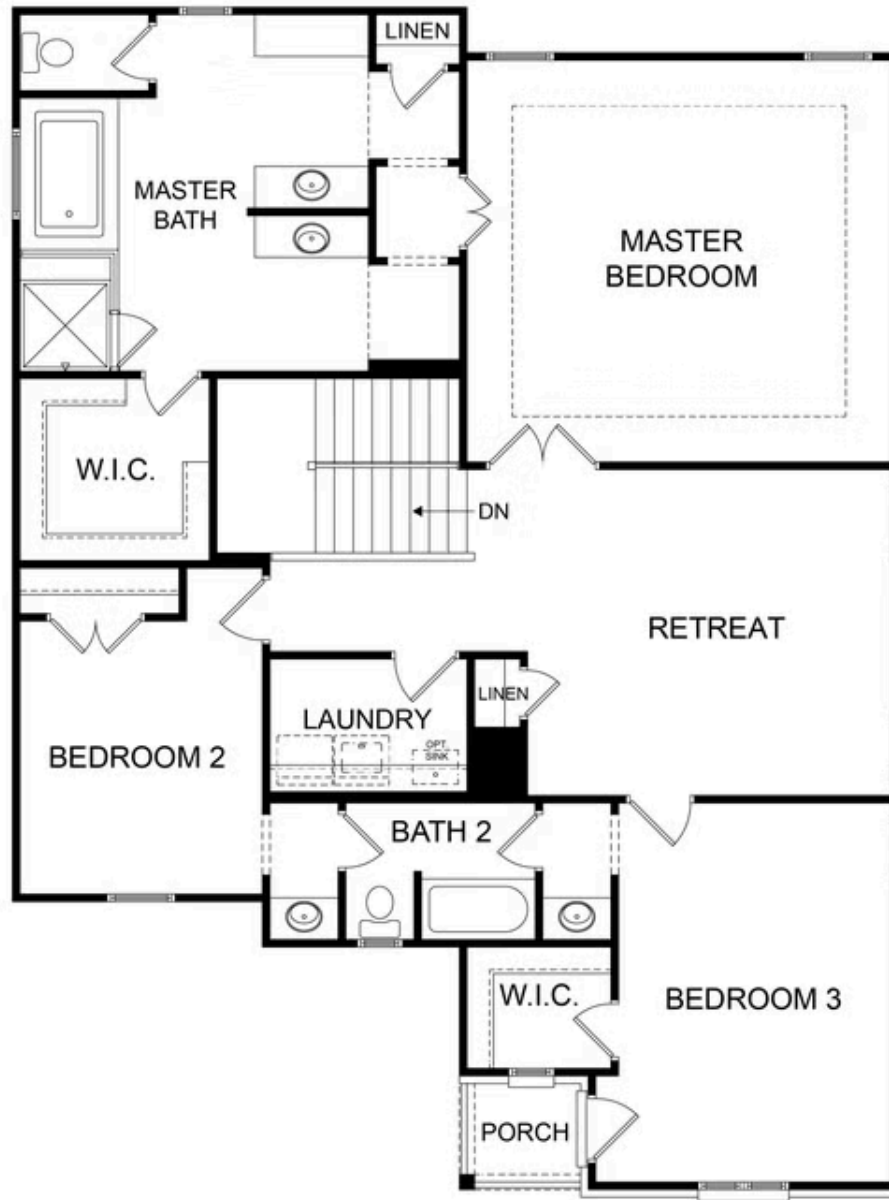

Want to Know More
About This Home?

CONTACT OUR COMMUNITY SALES MANAGER

NONE

Call Us @ (678) 332-7300

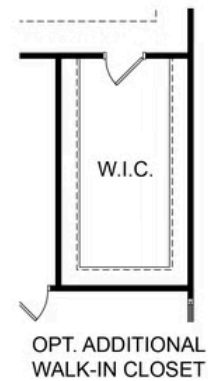
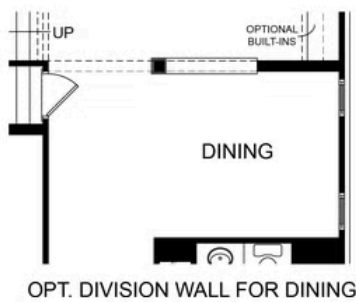
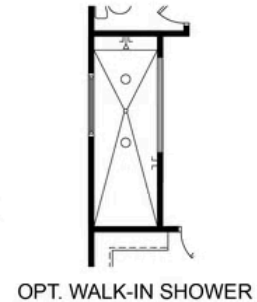
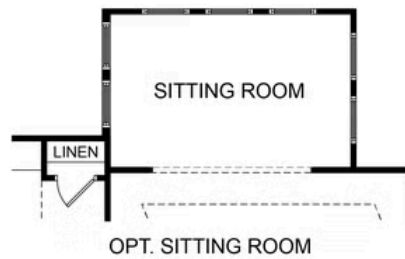
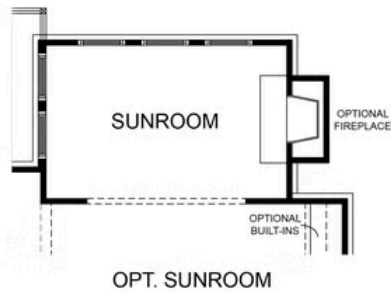

Want to Know More
About This Home?

CONTACT OUR COMMUNITY SALES MANAGER

NONE

Call Us @ (678) 332-7300