



PRICED AT
\$472,650

 1903 Sq Ft

 3 Beds

 3.5 Baths

 2 Car Garage

 3.0 Story

Elevate your life in 2023! New Year New Price Plus \$20k Any Way You Want on all contracts written before 2/28/2023 and closing by 3/31/2023. . Private views from large deck which is great for relaxation or entertaining is included in this plan! Location Location Location!!! Final Homes released at Suwanee Township, Don't Miss out on your opportunity to Live in this great Gated community!!! The popular Glendale Floor Plan by The Providence Group. This home also features a modern Linear Fireplace and the Design Package has been selected and included in price. This home will have the Linen Package- White Cabinets and White Quartz countertops! Del Ray Windsurf Birch Hardwood throughout, stairs are stained to match flooring, Only 3 bedrooms have carpet. This townhome is a spacious 3 story design floor plan offering a private entry and bedroom with full bath on terrace level. This is a 3 bedroom, 3.5 bath home with Your main level being Open Concept. The Upper level features a spacious owner's suite, secondary bedroom and Laundry room located in hallway. The highlight of the Glendale floor plan is that all the bedrooms have their own bathrooms. Suwanee Township is a gated community and amenity ...

**Want to Know More
About This Home?**

CONTACT OUR COMMUNITY SALES MANAGER
Call Us @ 470.462.9178



**Want to Know More
About This Home?**

CONTACT OUR COMMUNITY SALES MANAGER
Call Us @ 470.462.9178

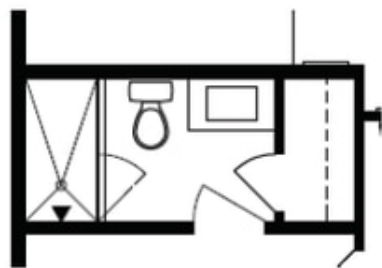

Optional Bath 3 Shower ilo Tub



Optional Owner's Luxury Shower

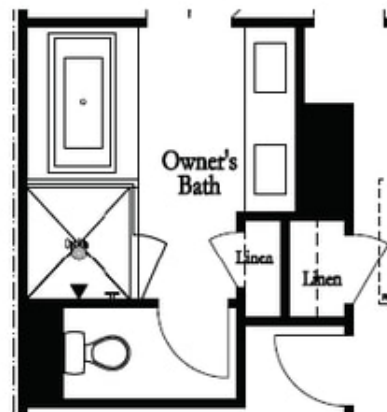

Optional Owner's Shower & Tub

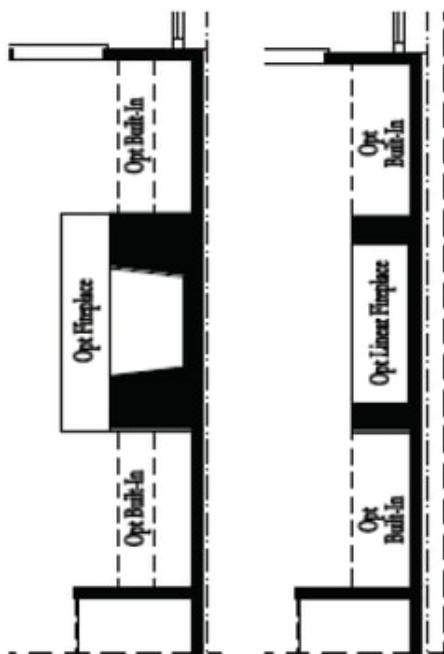

Optional
Family Room
Fireplace

Optional
Family Room
Linear Fireplace

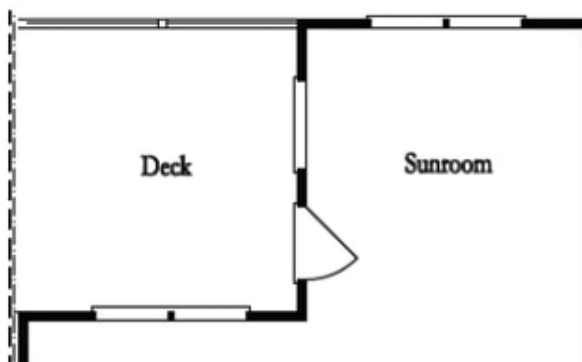

Optional Sunroom 1 ilo Extended Deck

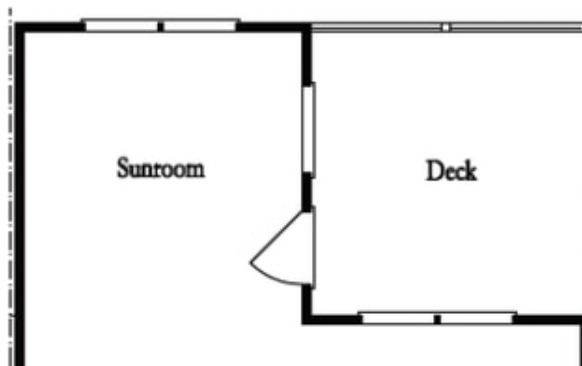

Optional Sunroom 2 ilo Extended Deck

**Want to Know More
About This Home?**

CONTACT OUR COMMUNITY SALES MANAGER
Call Us @ 470.462.9178