



PRICED AT  
**\$488,250**

 1994 Sq Ft

 3 Beds

 3.5 Baths

 2 Car Garage

 3.0 Story

**FINAL OPPORTUNITIES To : Elevate your life in 2023! New Year New Price Plus \$20k Any Way You Want on all contracts written before 1/31/2023 and closing by 3/31/2023. . Ask us or call for details. \*\*Don't Miss out on your opportunity to Live in this great Gated community. This townhome is a spacious 3 story design floor plan with a private entry and bedroom with full bath on terrace level. This 3 bedroom, 3.5 bath home features an open concept floor plan. A sunroom is located just off the family room and could double as a home office. Upstairs you will find the owners suite with spa like bath that includes a dual vanity, the upgraded Tub and separate Shower! This community is in highly desirable Suwanee and located within Level Creek Elementary & North Gwinnett High & Middle School district. Just a short 1.3 mile drive to Suwanee Town Center, access to interstates, shopping and restaurants. \* Preferred Lenders - Ameris Bank, Capital City Home Loans, New American Funding, Renasant Bank, and Prime Lending. \* Pictures are of a previously built home, Photos are for representation purposes only and are not of the actual property., Property is Framing ...**

**Want to Know More  
About This Home?**

CONTACT OUR NEW HOME NAVIGATOR  
Call Us @ 470.462.9178



**Want to Know More  
About This Home?**

CONTACT OUR NEW HOME NAVIGATOR  
Call Us @ 470.462.9178



Optional Bath 3 Shower ilo Tub



Optional Owner's Luxury Shower

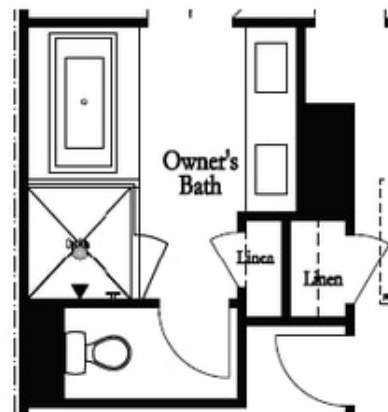

Optional Owner's Shower & Tub



Optional  
Family Room  
Fireplace

Optional  
Family Room  
Linear Fireplace



Optional Sunroom 1 ilo Extended Deck

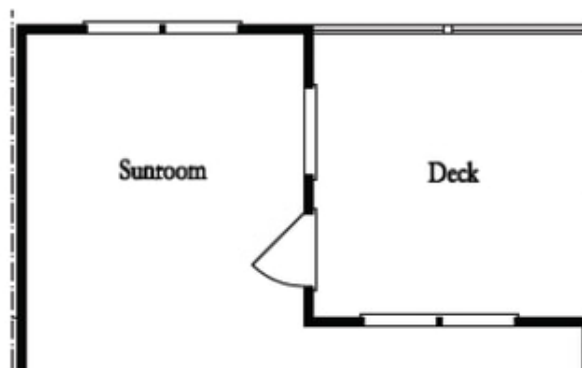

Optional Sunroom 2 ilo Extended Deck

**Want to Know More  
About This Home?**

CONTACT OUR NEW HOME NAVIGATOR  
Call Us @ 470.462.9178