



PRICED AT
\$488,800

 **1903 Sq Ft**

 **3 Beds**

 **3.5 Baths**

 **2 Car Garage**

 **3.0 Story**

Move in Ready!!! Can Close by December 19th , 2022!! This Glendale Floor Plan by The Providence Group has Linear Fireplace, Large deck for entertaining and Upgraded Walk in shower with Drying area in Master!! Design Package has been selected and included in price, this home will have White Cabinets and White Quartz countertops! This townhome is a spacious 3 story design floor plan offers private entry, bedroom with full bath on terrace level. This is a 3bedroom, 3.5 bath home with Your main level been Open Concept with a gourmet kitchen island, quartz countertops overlooking dining, family room leading onto the large deck for entertaining. The Upper level features spacious owner's suite and secondary bedroom and Laundry room located in hallway. The highlight of the Glendale floor plans that all the bedrooms have their own bathrooms. Suwanee Township is a gated community and amenity plan has a park, firepit and gazebo. This community is in highly desirable Suwanee and located within Level Creek Elementary & North Gwinnett High & Middle School district. Just a short 1.3mile drive to Suwanee Town Center, access to interstates, shopping and restaurants. Inquire about closing cost contribution incentive with our preferred lender * Pictures ...

**Want to Know More
About This Home?**

CONTACT OUR COMMUNITY SALES MANAGER
Call Us @ 470.462.9178



**Want to Know More
About This Home?**

CONTACT OUR COMMUNITY SALES MANAGER
Call Us @ 470.462.9178

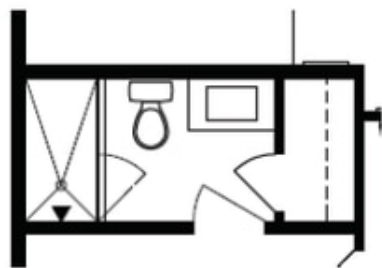

Optional Bath 3 Shower ilo Tub



Optional Owner's Luxury Shower

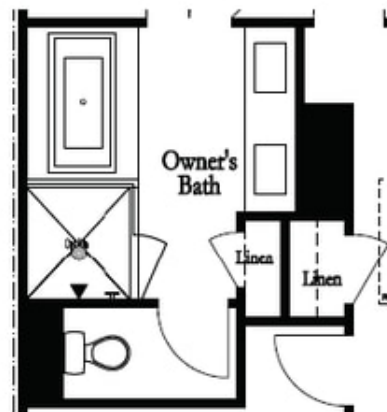

Optional Owner's Shower & Tub

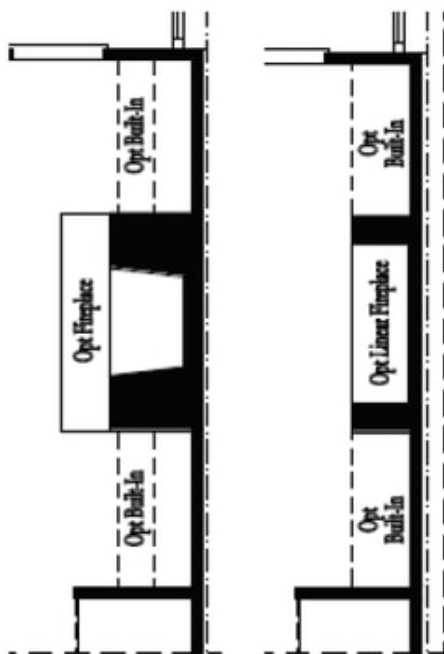

Optional
Family Room
Fireplace

Optional
Family Room
Linear Fireplace

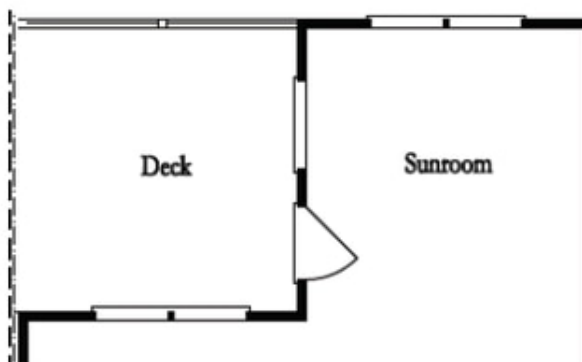

Optional Sunroom 1 ilo Extended Deck

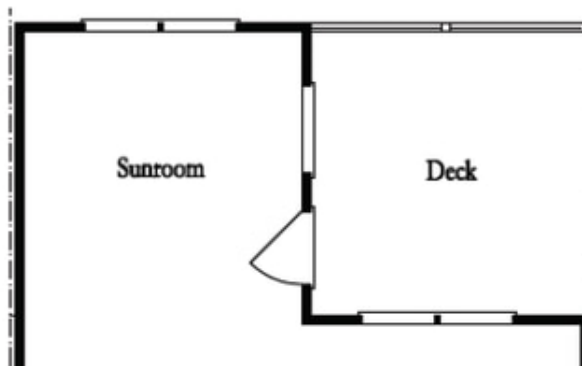

Optional Sunroom 2 ilo Extended Deck

**Want to Know More
About This Home?**

CONTACT OUR COMMUNITY SALES MANAGER
Call Us @ 470.462.9178