



PRICED AT
\$482,460

 1994 Sq Ft

 3 Beds

 3.5 Baths

 2 Car Garage

 3.0 Story

Glendale J1 Floor Plan by The Providence Group. Quick Move in home! Can close in 30 days!! Homesite 48 in Suwanee Townships, Suwanee's premier, gated townhome community located just minutes from Suwanee Town Center and Sims Lake Park. This home has a sunroom, fireplace, Owner's Walk-In Shower, and blinds are included. Stone Design Package. 3 bedroom, 3.5 bathroom. All bedrooms have their own bathroom! Available for Investors! * Pictures are of a previously built home, Photos are for representation purposes only and are not of the actual property., property is still under construction**

**Want to Know More
About This Home?**

CONTACT OUR COMMUNITY SALES MANAGER
Call Us @ 470.462.9178



Elevations B & C Floor Plan Layout

**Want to Know More
About This Home?**

CONTACT OUR COMMUNITY SALES MANAGER
Call Us @ 470.462.9178



FIRST FLOOR

Elevations B & C Floor Plan Layout

**Want to Know More
About This Home?**

CONTACT OUR COMMUNITY SALES MANAGER
Call Us @ 470.462.9178

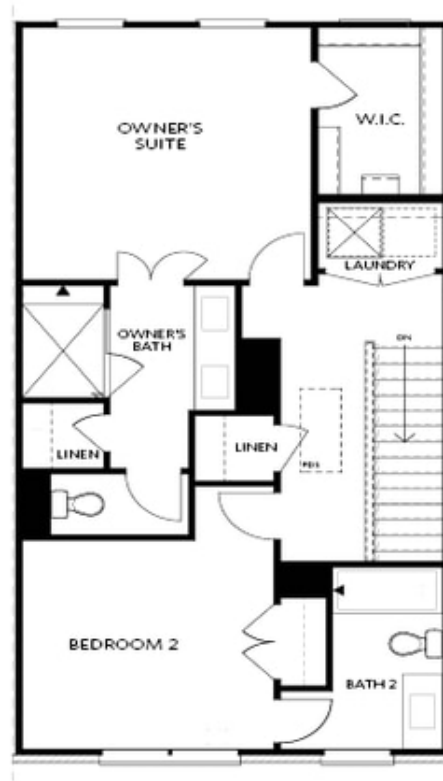

SECOND FLOOR

Elevations B & C Floor Plan Layout

**Want to Know More
About This Home?**

CONTACT OUR COMMUNITY SALES MANAGER
Call Us @ 470.462.9178



OPT Bath 3 Shower ilo
 Tub/Shower Combo



OPT Sunroom ilo Full Deck



OPT Owner's
 Walk-Through Shower

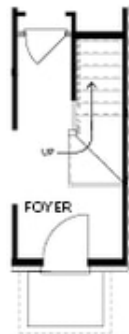

OPT Stair Landing
 on Terrace



OPT Fireplace



OPT Linear Fireplace



OPT Owner's Shower &
 Tub Combo

OPTIONS

Want to Know More
 About This Home?

CONTACT OUR COMMUNITY SALES MANAGER
 Call Us @ 470.462.9178