



PRICED AT
\$501,250

 2004 Sq Ft

 3 Beds

 3.5 Baths

 2 Car Garage

 3.0 Story

This is the one you've been waiting for!! Popular Garwood floor plan overlooking the private park Miroposa Park and Gazebo to be built for residents!! Location, Location Location!! This beautiful 3 story design floor offers entry on main level. Your main level is open concept with Stone design collection featuring Stone (Gray) Kitchen Cabinets in your gourmet kitchen island, Carrara Morro(White) quartz countertops overlooking dining, family room and sunroom. Enjoy the deck off the sunroom which is great for entertaining or just to relax. This home features a Linear Fireplace for you to enjoy. The Upper level features spacious owner's suite has upgraded large Walk in Shower with Drying area , quartz countertops, dual vanities. The laundry room is located in hallway on the upper level along with the secondary bedroom. On the garage level you will find the 3rd bedroom with a large walk in closet. The highlight of the Garwood floor plan is that all the bedrooms have their own bathrooms. Suwanee Townships is a gated community and amenity plan has a park, firepit and gazebo. This community is in highly desirable Suwanee and located within Level Creek Elementary & North Gwinnett High & Middle School district. ...

**Want to Know More
About This Home?**

CONTACT OUR COMMUNITY SALES MANAGER
Call Us @ 470.462.9178



**Want to Know More
About This Home?**

CONTACT OUR COMMUNITY SALES MANAGER
Call Us @ 470.462.9178

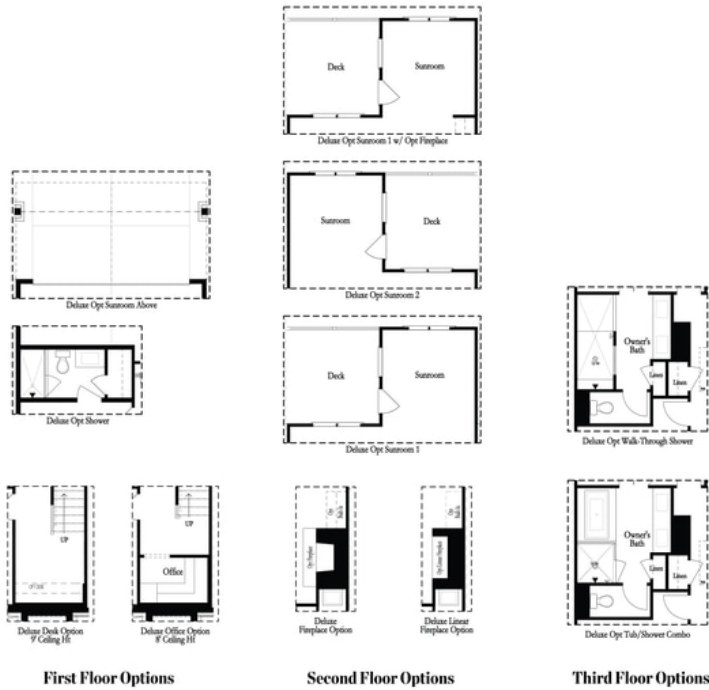

**Want to Know More
 About This Home?**

CONTACT OUR COMMUNITY SALES MANAGER
 Call Us @ 470.462.9178