

PRICED AT
\$513,750

 1994 Sq Ft

 3 Beds

 3.5 Baths

 2 Car Garage

 3.0 Story

Last Garwood End Unit!! This is the one you've been waiting for!! Popular Garwood floor plan overlooking the private park Miroposa Park and Gazebo to be built for residents!! Location, Location Location!! This beautiful 3 story design floor offers entry on main level. 3bedroom, 3.5 bath Each bedroom has its onw private bathroom. Upgrades In this home Include: Linear Fireplace, Sunroom & Owner's bathroom has Tub shower. Design already selected- Linen Collection in this Design Package. Suwanee Towneship is a gated community and amenity plan has a park, firepit and gazebo. This community is in highly desirable Suwanee and located within Level Creek Elementary & North Gwinnett High & Middle School district. Just a short 1.3mile drive to Suwanee Town Center, access to interstates, shopping and restaurants & Sims Lake Park. ** Home is under construction ** estimated completion October 2022* Pictures are of a previously built home and Not of Actual Home**

**Want to Know More
About This Home?**

CONTACT OUR COMMUNITY SALES MANAGER
Call Us @ 470.462.9178



**Want to Know More
About This Home?**

CONTACT OUR COMMUNITY SALES MANAGER
Call Us @ 470.462.9178

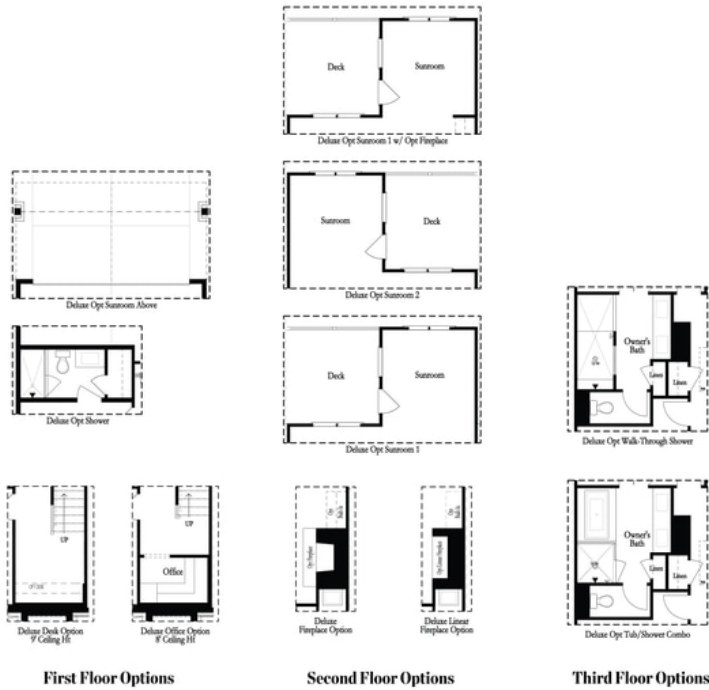

**Want to Know More
 About This Home?**

CONTACT OUR COMMUNITY SALES MANAGER
 Call Us @ 470.462.9178