



PRICED AT
\$487,180

 2004 Sq Ft

 3 Beds

 3.5 Baths

 2 Car Garage

 3.0 Story

Garwood H Floor Plan by The Providence Group. Prime location overlooking Miraposa Parks and Gazebo in front and private views from your deck and sunroom overlooking the tree save area. This beautiful interior unit is a 3 story design floor offers entry on main level. Your main level is Open Concept with White Kitchen Cabinets in your gourmet kitchen island, Carrara Morro White quartz countertops overlooking dining, family room and sunroom. Popular Emergence Kismet LVP throughout and only carpet in bedrooms. Enjoy the deck off the sunroom which is great for entertaining or just to relax with relaxing views of Tree save area. The Upper level features spacious owner's suite has frameless shower with quartz countertops, dual vanities. The laundry room is located in hallway on the upper level along with the secondary bedroom. On the garage level you will find the 3rd bedroom with a large walk in closet. The highlight of the Garwood floor plan is that all the bedrooms have their own bathrooms. Suwanee Townships is a gated community and amenity plan has a park, firepit and gazebo. This community is in highly desirable Suwanee and located within Level Creek Elementary & North Gwinnett High & Middle ...

**Want to Know More
About This Home?**

CONTACT OUR COMMUNITY SALES MANAGER
Call Us @ 470.462.9178



**Want to Know More
 About This Home?**

CONTACT OUR COMMUNITY SALES MANAGER
 Call Us @ 470.462.9178

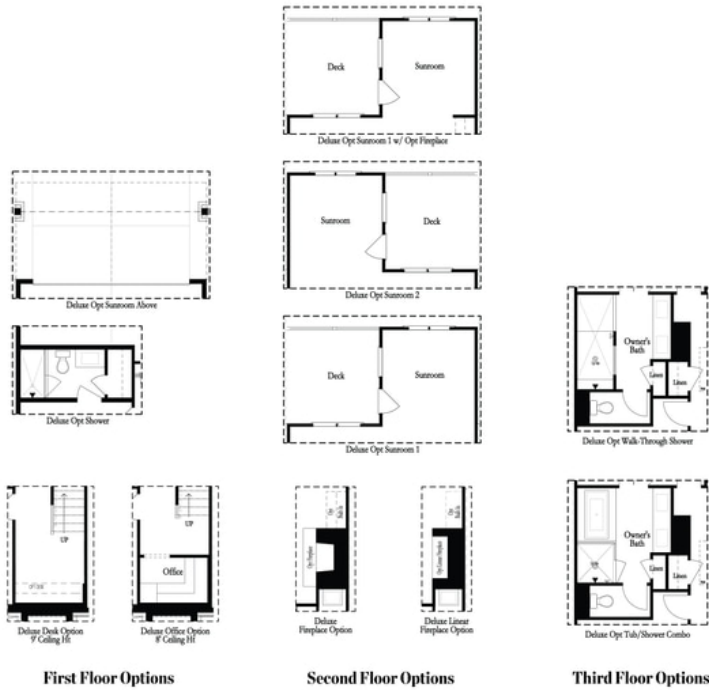

**Want to Know More
 About This Home?**

CONTACT OUR COMMUNITY SALES MANAGER
 Call Us @ 470.462.9178