

PRICED AT
\$478,250

 1994 Sq Ft

 3 Beds

 3.5 Baths

 2 Car Garage

 3.0 Story

Garwood H Floor Plan by The Providence Group. Prime location highly anticipated overlooking Miraposa Park and Gazebo. This beautiful 3 story design floor offers entry on main level. Your main level is Open Concept with White Kitchen Cabinets in your gourmet kitchen island, Carrara Morro White quartz countertops overlooking dining, family room with the upgraded modern Linear fireplace and sunroom. Enjoy the deck off the sunroom which is great for entertaining or just to relax. The Upper level features spacious owner's suite has a frameless shower, quartz countertops, dual vanities. ** Home is under construction ** The laundry room is located in hallway on the upper level along with the secondary bedroom. On the garage level you will find the 3rd bedroom with a large walk in closet. The highlight of the Garwood floor plan is that all the bedrooms have their own bathrooms. Suwanee Townships is a gated community and amenity plan has a park, firepit and gazebo. This community is in highly desirable Suwanee and located within Level Creek Elementary & North Gwinnett High & Middle School district. Just a short 1.3mile drive to Suwanee Town Center, access to interstates, shopping and restaurants & Sims Lake Park. This ...

**Want to Know More
About This Home?**

CONTACT OUR COMMUNITY SALES MANAGER
Call Us @ 470.462.9178



**Want to Know More
 About This Home?**

CONTACT OUR COMMUNITY SALES MANAGER
 Call Us @ 470.462.9178

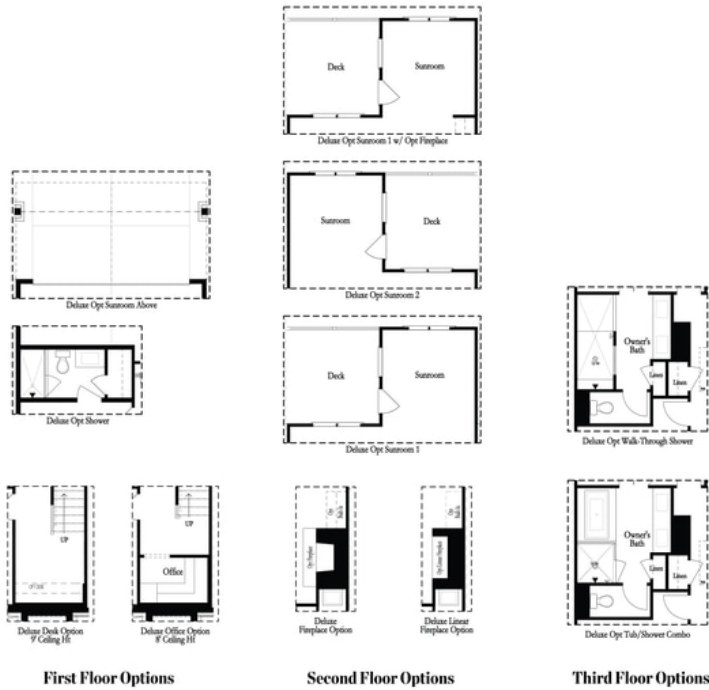

**Want to Know More
 About This Home?**

CONTACT OUR COMMUNITY SALES MANAGER
 Call Us @ 470.462.9178