



PRICED AT
\$493,800

 2004 Sq Ft

 3 Beds

 3.5 Baths

 2 Car Garage

 3.0 Story

Garwood B Floor Plan by The Providence Group. Prime location highly anticipated overlooking Gazebo & Miraposa Park. Enjoy the privacy from your deck and sunroom looking onto the Tree save area! *3 story TH, 3 bdrm, 3.5 bath. A Great Feature of this floor plan is all bdrms have their own bthrms! Master Bath has a HUGE walk in shower. Private front entry leads to an open concept on the main level. Sunroom gives extra entertaining space. Beautiful designer touches with stone countertops in kitchen & master bath. The perfect location with easy access to interstates, downtown Suwanee. Awesome shopping, restaurants & schools nearby. *Home is UNDER CONSTRUCTION & est to be completed in July/Aug 2022. *Pictures are of a previously built home by The Providence Group!** Come on in and personalize your home and choose your design package** Limited Time**!!

**Want to Know More
About This Home?**

CONTACT OUR COMMUNITY SALES MANAGER
Call Us @ 470.462.9178



**Want to Know More
About This Home?**

CONTACT OUR COMMUNITY SALES MANAGER
Call Us @ 470.462.9178

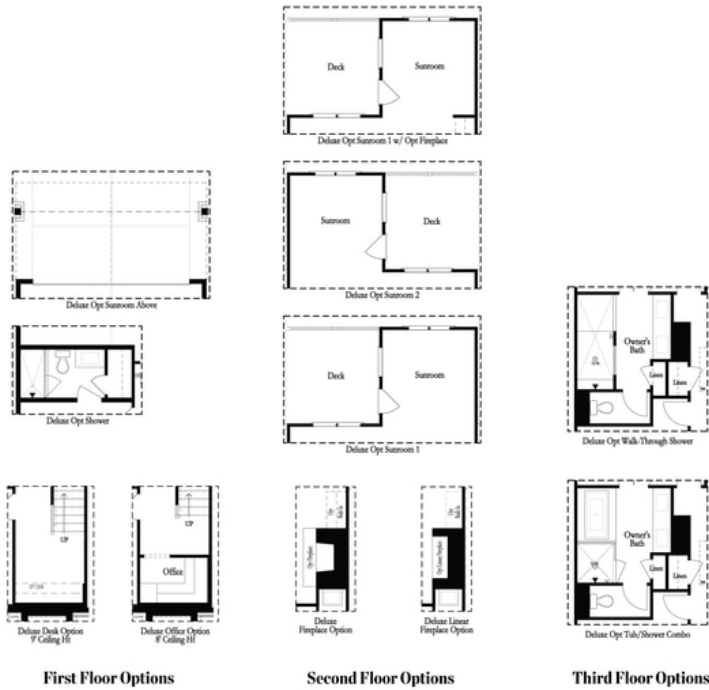

Want to Know More
 About This Home?

CONTACT OUR COMMUNITY SALES MANAGER
 Call Us @ 470.462.9178