



PRICED AT
\$462,090

 2004 Sq Ft

 3 Beds

 3.5 Baths

 2 Car Garage

 3.0 Story

Glendale J1 Floor Plan by The Providence Group. PRIME location overlooking the park with Gazebo !!! This 3 story design floor plan offers private entry, bedroom with full bath on terrace level. Beautiful Open Concept main floor includes your gourmet kitchen for your favorite meals. Large island with quartz countertops overlooks your dining, family room & sunroom which leads to you deck for relaxing or entertaining. The Upper level features spacious owner's suite has upgraded oversized walk in shower with drying area with quartz countertops & dual vanities. The laundry room is located in hallway on the upper level along with the secondary bedroom. The highlight of the Glendale floor plans that all the bedrooms have their own bathrooms. Suwanee Townships is a gated community and amenity plan has a park, firepit and gazebo. This community is in highly desirable Suwanee and located within Level Creek Elementary & North Gwinnett High & Middle School district. Just a short 1.3mile drive to Suwanee Town Center, access to interstates, shopping and restaurants. This home is Under Construction-Estimated completion June 2022 * Pictures are of a previously built home** Limited time to choose your design package!!

**Want to Know More
About This Home?**

CONTACT OUR COMMUNITY SALES MANAGER
Call Us @ 470.462.9178



**Want to Know More
About This Home?**

CONTACT OUR COMMUNITY SALES MANAGER
Call Us @ 470.462.9178

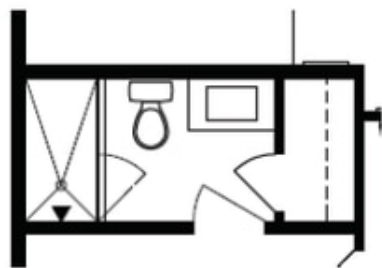

Optional Bath 3 Shower ilo Tub



Optional Owner's Luxury Shower

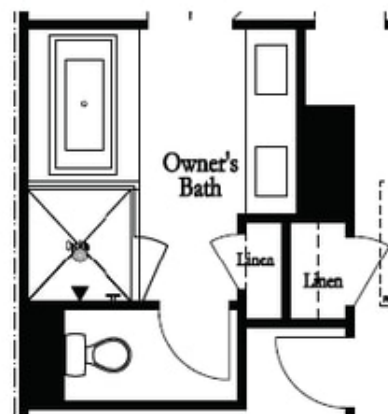

Optional Owner's Shower & Tub

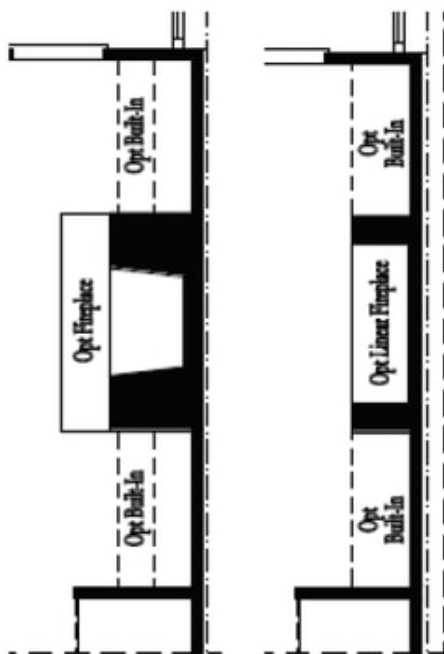

Optional
Family Room
Fireplace

Optional
Family Room
Linear Fireplace

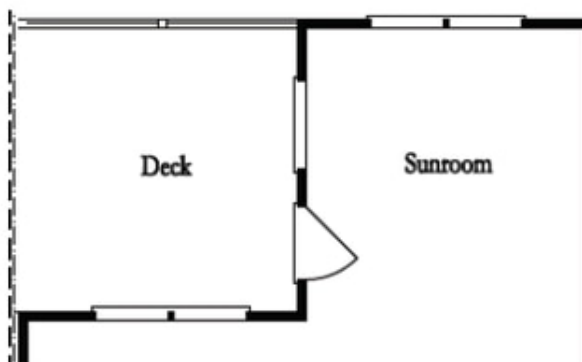

Optional Sunroom 1 ilo Extended Deck

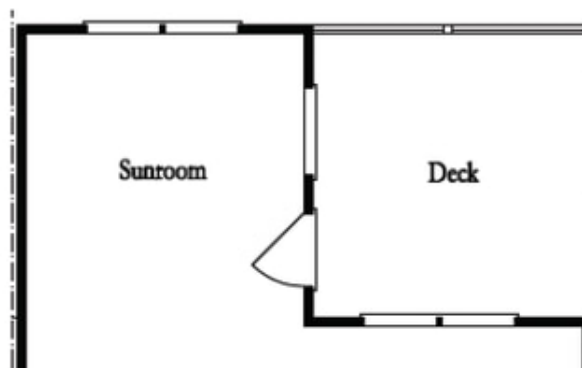

Optional Sunroom 2 ilo Extended Deck

**Want to Know More
About This Home?**

CONTACT OUR COMMUNITY SALES MANAGER
Call Us @ 470.462.9178