







PRICED AT
\$440,400

-  2004 Sq Ft
-  3 Beds
-  3.5 Baths
-  2 Car Garage
-  3.0 Story

Glendale D Floor Plan by The Providence Group. This highly desirable spacious 3 story design floor plan offers private entry, bedroom with full bath on terrace level. Your main level is Open Concept with a gourmet kitchen island, quartz countertops overlooking dining, family room, sun room and cozy deck. The Upper level features spacious owner's suite with an upgraded oversized frameless shower with drying area, quartz countertops, dual vanities and walk in closet. The laundry room is located in hallway on the upper level along with the secondary bedroom. The highlight of the Glendale floor plans that all the bedrooms have their own bathrooms. Suwanee Townships is a gated community and amenity plan has a park, firepit and gazebo. This community is in highly desirable Suwanee and located within Level Creek Elementary & North Gwinnett High & Middle School district. Just a short 1.3mile drive to Suwanee Town Center, access to interstates, shopping and restaurants. This home is Under Construction-Estimated completion May/June 2022 * Pictures are of a previously built home**

**Want to Know More
About This Home?**

CONTACT OUR COMMUNITY SALES MANAGER
Call Us @ 470.462.9178



TERRACE

Elevations B & C Floor Plan Layout

**Want to Know More
About This Home?**

CONTACT OUR COMMUNITY SALES MANAGER
Call Us @ 470.462.9178



FIRST FLOOR

Elevations B & C Floor Plan Layout

**Want to Know More
About This Home?**

CONTACT OUR COMMUNITY SALES MANAGER
Call Us @ 470.462.9178



SECOND FLOOR

Elevations B & C Floor Plan Layout

**Want to Know More
About This Home?**

CONTACT OUR COMMUNITY SALES MANAGER
Call Us @ 470.462.9178

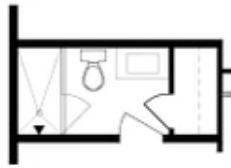

OPT Bath 3 Shower ilo
 Tub/Shower Combo



OPT Sunroom ilo Full Deck



OPT Owner's
 Walk-Through Shower

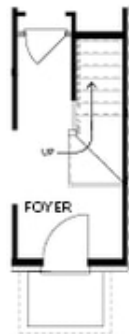

OPT Stair Landing
 on Terrace



OPT Fireplace



OPT Linear Fireplace



OPT Owner's Shower &
 Tub Combo

OPTIONS

Want to Know More
 About This Home?

CONTACT OUR COMMUNITY SALES MANAGER
 Call Us @ 470.462.9178