



PRICED AT  
**\$535,000**

 1903 Sq Ft

 3 Beds

 3.5 Baths

 2 Car Garage

 3.0 Story

Don't Miss out on this Quick Move in home!!!- Can close in 30 days! Garwood B Floor Plan by The Providence Group. This popular 3 story design floor offers entry on main level. Upgrades in this home include: Hardwood throughout, Linear Fireplace and Owner's Walk in Shower with Drying area!! Enjoy the large deck which is great for entertaining or just to relax. The Upper level features spacious owner's suite has the popular upgraded oversized shower with drying area, quartz countertops, dual vanities. The laundry room is located in hallway on the upper level along with the secondary bedroom. The 3rd bedroom is located on Garage level which offers privacy and has a walk in closet. The highlight of the Garwood floor plan is that all the bedrooms have their own bathrooms. Suwanee Towneship is a gated community and amenity plan has a park, firepit and gazebo. This community is in highly desirable Suwanee and located within Level Creek Elementary & North Gwinnett High & Middle School district. Just a short 1.3mile drive to Suwanee Town Center, access to interstates, shopping and restaurants & Sims Lake Park. \*\*\* Home can close in 30 days No investors \*\*\*\*\* Highest and Best ...

**Want to Know More  
About This Home?**

CONTACT OUR COMMUNITY SALES MANAGER  
Call Us @ 470.462.9178



**Want to Know More  
 About This Home?**

CONTACT OUR COMMUNITY SALES MANAGER  
 Call Us @ 470.462.9178

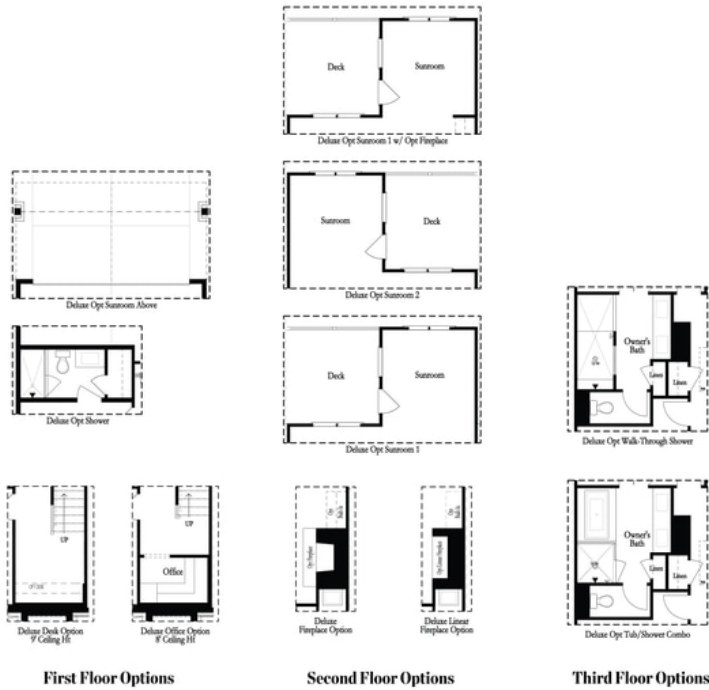

**Want to Know More  
 About This Home?**

CONTACT OUR COMMUNITY SALES MANAGER  
 Call Us @ 470.462.9178