



PRICED AT
\$442,920

 1994 Sq Ft

 3 Beds

 3.5 Baths

 2 Car Garage

 3.0 Story

Garwood H Floor Plan by The Providence Group. This popular 3 story design floor offers entry on main level. Welcome your guests on the Open concept main level with a gourmet kitchen island, quartz countertops overlooking dining, family room and sunroom. Enjoy the deck off the sunroom which is great for entertaining or just to relax. The Upper level features spacious owner's suite has the popular upgraded oversized shower with drying area, quartz countertops, dual vanities. The laundry room is located in hallway on the upper level along with the secondary bedroom. The 3rd bedroom is located on Garage level which offers privacy and has a walk in closet. The highlight of the Garwood floor plan is that all the bedrooms have their own bathrooms. Suwanee Towneship is a gated community and amenity plan has a park, firepit and gazebo. This community is in highly desirable Suwanee and located within Level Creek Elementary & North Gwinnett High & Middle School district. Just a short 1.3mile drive to Suwanee Town Center, access to interstates, shopping and restaurants & Sims Lake Park. This home is to be built estimated completion Feb/March 2022* Pictures are of a previously built home and Not of ...

Want to Know More
About This Home?

CONTACT OUR COMMUNITY SALES MANAGER
Call Us @ 470.462.9178



**Want to Know More
About This Home?**

CONTACT OUR COMMUNITY SALES MANAGER
Call Us @ 470.462.9178

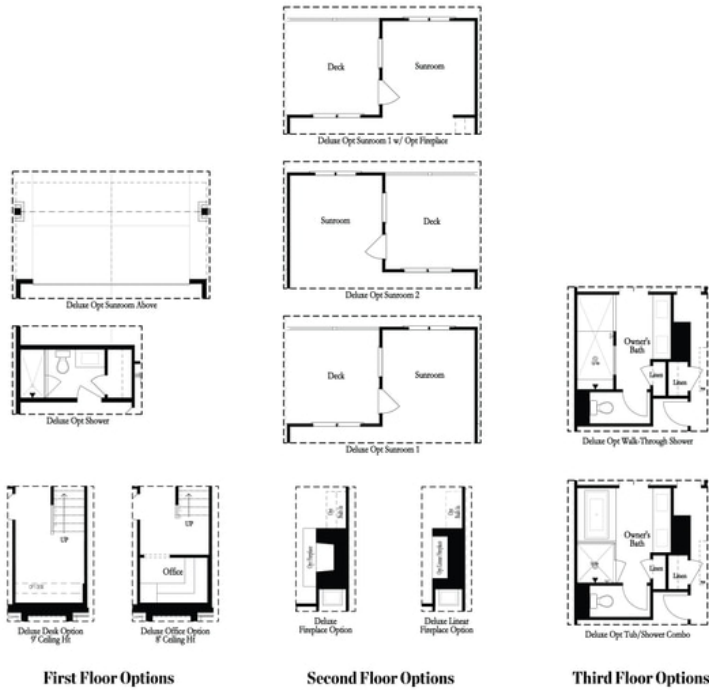

**Want to Know More
 About This Home?**

CONTACT OUR COMMUNITY SALES MANAGER
 Call Us @ 470.462.9178